

ALL EXISTING LINEMARKING (BICYCLE, PEDESTRIAN, ARROW SIGN, ETC) ARE TO BE REINSTATED AS APPROVED BY THE COUNCIL SUPERINTENDENT.

SHARED PATH TYPICAL CROSS SECTION  
NOT TO SCALE

LEGEND

- RECONSTRUCT ASPHALT SHARED PATH AS PER COUNCIL STD DWG STD-413 AND DETAILS ON SHEET 2
- SETOUT POINT
- CURVE SETOUT



DETAIL PLAN

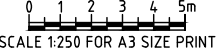

SCALE 1:250 FOR A3 SIZE PRINT

**WARNING AND DISCLAIMER  
BEWARE OF UNDERGROUND SERVICES**  
THE LOCATION OF UNDERGROUND SERVICES PLOTTED IN THESE DRAWINGS ARE APPROXIMATE ONLY. THEREFORE IT IS THE RESPONSIBILITY OF THE CONTRACTOR TO PROVE THEIR EXACT POSITIONS ON SITE. FURTHERMORE, OTHER SERVICES MAY EXIST OF WHICH STONNINGTON CITY COUNCIL ARE UNAWARE. THEREFORE, THE INFORMATION PROVIDED NEEDS TO BE VERIFIED BY THE RELEVANT SERVICE AUTHORITIES



**IMPORTANT NOTE !**  
TRENCH SUPPORT MUST BE PROVIDED FOR DEPTH GREATER THAN 1.5m AS PER THE MINES ACT 1958. WORKSAFE VICTORIA TO BE CONTACTED 3 DAYS PRIOR TO EXCAVATION WORKS FOR TRENCHES GREATER THAN 15m

ISSUED FOR CONSTRUCTION

EXISTING LEGEND		AMENDMENT DESCRIPTION		DATE	APPROVED BY
	PERMANENT SURVEY MARK	1	----	----	----
	SURVEY STATION	2	----	----	----
	TRAVERSE LINE	3	----	----	----
	ELECTRICITY CABLE	4	----	----	----
	GAS MAIN	5	----	----	----
	SEWER MAIN				
	TELECOM CABLE				
	WATER MAIN				
	DRAINAGE LINE				
	PROPERTY STORMWATER				
	JUNCTION PIT				
	GRADED PIT				
	ELECTRICITY PIT				
	ELECTRICITY POLE				
	ELECTRICITY POLE & LIGHT				
	STAY ANCHOR				
	TRAM POLE				
	TRAM POLE & LIGHT				
	TRAFFIC LIGHT				
	TRAFFIC SIGNAL COVERS				
	TRAFFIC SIGNAL BOX				
	POST BOX				
	LITTER BIN				
	BENCH-SEAT				
	SEWER VENT				
	SEWER MANHOLE / IO				
	FIRE PLUG				
	FIRE HYDRANT				
	WATER VALVE				
	GAS VALVE				
	TELECOM PIT				
	TELECOM CABINET				
	PUBLIC TELEPHONE				
	POST BOX				
	LITTER BIN				
	BENCH-SEAT				

STONNINGTON  
Engineering Department  
DESIGN & PROJECT MANAGEMENT

CITY OF STONNINGTON  
311 Glenferrie Road, Malvern, Victoria  
PO Box 58, Malvern 3144 Tel 8290 1333

Initials	Date	CAD Reference
Designed NP	6/05/2021	CANTERBURY ROAD
Drawn NP	6/05/2021	File Reference TBA
Checked MS		
Approved		Level Datum A.H.D.
Infrastructure Manager	Date	Surveyor SURFCOAST
Client	Date	FB

GARDINER CREEK SHARED PATH  
BETWEEN BURKE ROAD AND ELM ROAD,  
GLEN IRIS  
DETAIL PLAN 1 AND TYPICAL CROSS SECTION

SCALE: H. as shown V. as shown  
DRAWING NUMBER 2019-015  
Amendment No. SHEET 2 OF 20

2019-015  
DRAWING NUMBER

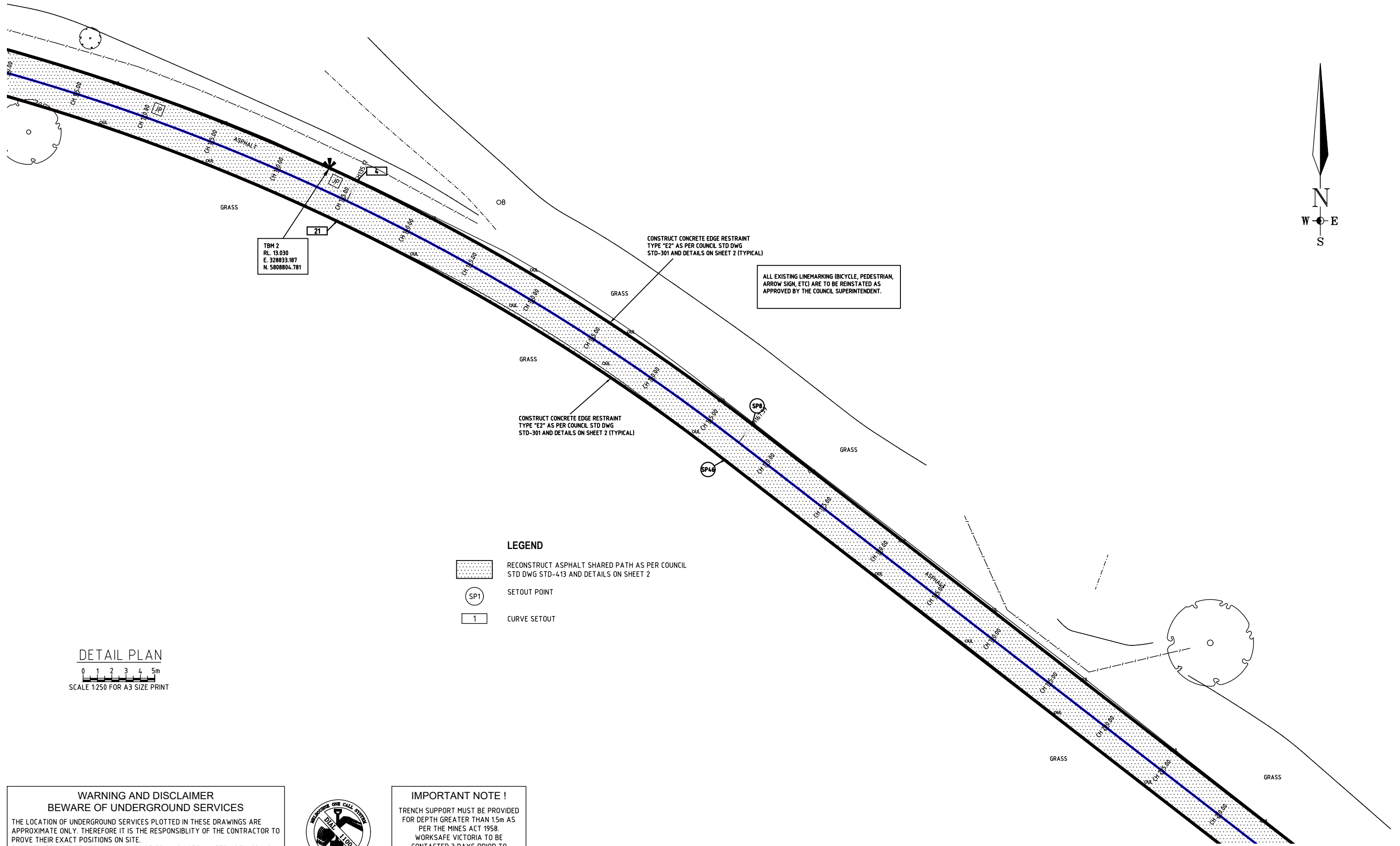

ALL EXISTING LINEMARKING (BICYCLE, PEDESTRIAN, ARROW SIGN, ETC) ARE TO BE REINSTATED AS APPROVED BY THE COUNCIL SUPERINTENDENT.

- LEGEND**
- RECONSTRUCT ASPHALT SHARED PATH AS PER COUNCIL STD DWG STD-413 AND DETAILS ON SHEET 2
  - SETOUT POINT
  - CURVE SETOUT

**DETAIL PLAN**  
 0 1 2 3 4 5m  
 SCALE 1:250 FOR A3 SIZE PRINT

**WARNING AND DISCLAIMER  
 BEWARE OF UNDERGROUND SERVICES**  
 THE LOCATION OF UNDERGROUND SERVICES PLOTTED IN THESE DRAWINGS ARE APPROXIMATE ONLY. THEREFORE IT IS THE RESPONSIBILITY OF THE CONTRACTOR TO PROVE THEIR EXACT POSITIONS ON SITE. FURTHERMORE, OTHER SERVICES MAY EXIST OF WHICH STONNINGTON CITY COUNCIL ARE UNAWARE. THEREFORE, THE INFORMATION PROVIDED NEEDS TO BE VERIFIED BY THE RELEVANT SERVICE AUTHORITIES



**IMPORTANT NOTE !**  
 TRENCH SUPPORT MUST BE PROVIDED FOR DEPTH GREATER THAN 1.5m AS PER THE MINES ACT 1958. WORKSAFE VICTORIA TO BE CONTACTED 3 DAYS PRIOR TO EXCAVATION WORKS FOR TRENCHES GREATER THAN 15m

**ISSUED FOR CONSTRUCTION**

EXISTING LEGEND	
	PERMANENT SURVEY MARK
	SURVEY STATION
	TRAVERSE LINE
	ELECTRICITY CABLE
	GAS MAIN
	SEWER MAIN
	TELECOM CABLE
	WATER MAIN
	DRAINAGE LINE
	PROPERTY STORMWATER
	JUNCTION PIT
	GRATED PIT
	ELECTRICITY PIT
	ELECTRICITY POLE & LIGHT
	STAY ANCHOR
	TRAM POLE
	TRAM POLE & LIGHT
	TRAFFIC LIGHT
	TRAFFIC SIGNAL COVERS
	TRAFFIC SIGNAL BOX
	POST BOX
	BOLLARD
	SEWER VENT
	SEWER MANHOLE / IO
	FIRE PLUG
	FIRE HYDRANT
	WATER VALVE
	GAS VALVE
	TELECOM PIT
	TELECOM CABINET
	PUBLIC TELEPHONE
	POST BOX
	LITTER BIN
	BENCH-SEAT

NUMBER	AMENDMENT DESCRIPTION	DATE	APPROVED BY
1	----	----	----
2	----	----	----
3	----	----	----
4	----	----	----
5	----	----	----

**STONNINGTON**  
 Engineering Department  
 DESIGN & PROJECT MANAGEMENT

**CITY OF STONNINGTON**  
 311 Glenferrie Road, Malvern, Victoria  
 PO Box 58, Malvern 3144 Tel 8290 1333

Initials	Date	CAD Reference
Designed NP	6/05/2021	CANTERBURY ROAD
Drawn NP	6/05/2021	File Reference TBA
Checked MS		
Approved		Level Datum A.H.D.
Infrastructure Manager	Date	Surveyor SURFCOAST
Client	Date	FB

**GARDINER CREEK SHARED PATH**  
 BETWEEN BURKE ROAD AND ELM ROAD,  
 GLEN IRIS  
 DETAIL PLAN 2

SCALE: H. as shown  
 V. as shown

DRAWING NUMBER: 2019-015  
 Amendment No. [ ] [ ] [ ] [ ]  
 SHEET 3 OF 20

DRAWING NUMBER: 2019-015

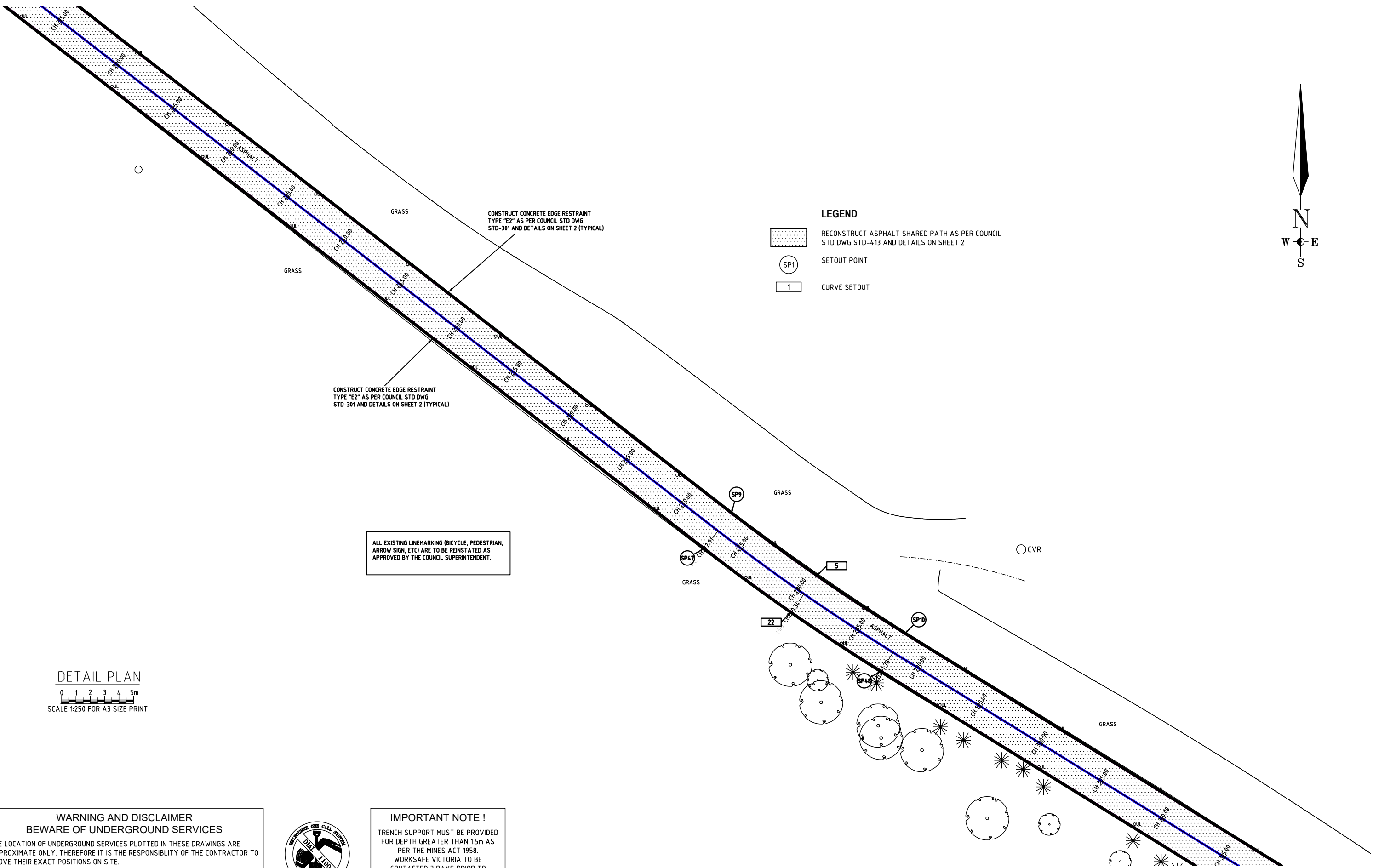

**LEGEND**

- RECONSTRUCT ASPHALT SHARED PATH AS PER COUNCIL STD DWG STD-413 AND DETAILS ON SHEET 2
- SETOUT POINT
- CURVE SETOUT



**DETAIL PLAN**

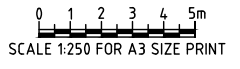

ALL EXISTING LINEMARKING (BICYCLE, PEDESTRIAN, ARROW SIGN, ETC) ARE TO BE REINSTATED AS APPROVED BY THE COUNCIL SUPERINTENDENT.

**WARNING AND DISCLAIMER  
BEWARE OF UNDERGROUND SERVICES**

THE LOCATION OF UNDERGROUND SERVICES PLOTTED IN THESE DRAWINGS ARE APPROXIMATE ONLY. THEREFORE IT IS THE RESPONSIBILITY OF THE CONTRACTOR TO PROVE THEIR EXACT POSITIONS ON SITE. FURTHERMORE, OTHER SERVICES MAY EXIST OF WHICH STONNINGTON CITY COUNCIL ARE UNAWARE. THEREFORE, THE INFORMATION PROVIDED NEEDS TO BE VERIFIED BY THE RELEVANT SERVICE AUTHORITIES



**IMPORTANT NOTE !**

TRENCH SUPPORT MUST BE PROVIDED FOR DEPTH GREATER THAN 1.5m AS PER THE MINES ACT 1958. WORKSAFE VICTORIA TO BE CONTACTED 3 DAYS PRIOR TO EXCAVATION WORKS FOR TRENCHES GREATER THAN 15m

ISSUED FOR CONSTRUCTION

EXISTING LEGEND	
	PERMANENT SURVEY MARK
	SURVEY STATION
	ELECTRICITY CABLE
	GAS MAIN
	SEWER MAIN
	TELECOM CABLE
	WATER MAIN
	DRAINAGE LINE
	PROPERTY STORMWATER
	JUNCTION PIT
	GRATED PIT
	ELECTRICITY PIT
	ELECTRICITY POLE & LIGHT
	STAY ANCHOR
	TRAM POLE
	TRAM POLE & LIGHT
	TRAFFIC LIGHT
	TRAFFIC SIGNAL COVERS
	TRAFFIC SIGNAL BOX
	POST BOX
	BOLLARD
	SEWER VENT
	SEWER MANHOLE / ID
	FIRE PLUG
	FIRE HYDRANT
	WATER VALVE
	GAS VALVE
	TELECOM PIT
	TELECOM CABINET
	PUBLIC TELEPHONE
	LITTER BIN
	BENCH-SEAT

NUMBER	AMENDMENT DESCRIPTION	DATE	APPROVED BY
1	----	----	----
2	----	----	----
3	----	----	----
4	----	----	----
5	----	----	----

**STONNINGTON**  
Engineering Department  
DESIGN & PROJECT MANAGEMENT

**CITY OF STONNINGTON**  
311 Glenferrie Road, Malvern, Victoria  
PO Box 58, Malvern 3144 Tel 8290 1333

Initials	Date	CAD Reference
Designed NP	6/05/2021	CANTERBURY ROAD
Drawn NP	6/05/2021	File Reference TBA
Checked MS		Level Datum A.H.D.
Approved		Surveyor SURFCOAST
Infrastructure Manager	Date	FB
Client	Date	

**GARDINER CREEK SHARED PATH**  
BETWEEN BURKE ROAD AND ELM ROAD,  
GLEN IRIS  
DETAIL PLAN 3

SCALE: H. as shown  
V. as shown

DRAWING NUMBER: 2019-015  
Amendment No. [ ]  
SHEET 4 OF 20

DRAWING NUMBER: 2019-015

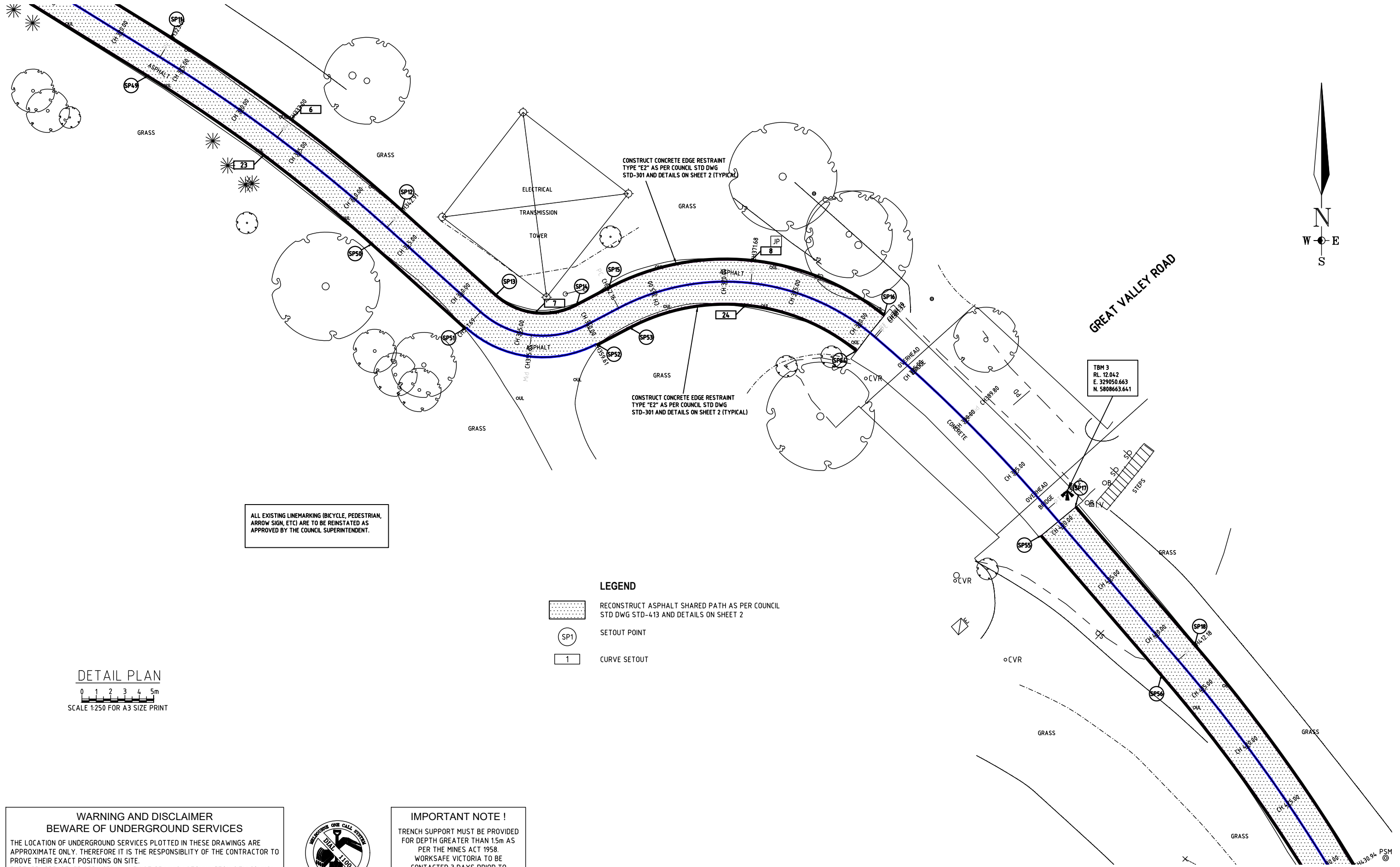

ALL EXISTING LINEMARKING (BICYCLE, PEDESTRIAN, ARROW SIGN, ETC) ARE TO BE REINSTATED AS APPROVED BY THE COUNCIL SUPERINTENDENT.

**LEGEND**

- RECONSTRUCT ASPHALT SHARED PATH AS PER COUNCIL STD DWG STD-413 AND DETAILS ON SHEET 2
- SETOUT POINT
- CURVE SETOUT

**DETAIL PLAN**  
 0 1 2 3 4 5m  
 SCALE 1:250 FOR A3 SIZE PRINT

**WARNING AND DISCLAIMER  
 BEWARE OF UNDERGROUND SERVICES**  
 THE LOCATION OF UNDERGROUND SERVICES PLOTTED IN THESE DRAWINGS ARE APPROXIMATE ONLY. THEREFORE IT IS THE RESPONSIBILITY OF THE CONTRACTOR TO PROVE THEIR EXACT POSITIONS ON SITE. FURTHERMORE, OTHER SERVICES MAY EXIST OF WHICH STONNINGTON CITY COUNCIL ARE UNAWARE. THEREFORE, THE INFORMATION PROVIDED NEEDS TO BE VERIFIED BY THE RELEVANT SERVICE AUTHORITIES



**IMPORTANT NOTE !**  
 TRENCH SUPPORT MUST BE PROVIDED FOR DEPTH GREATER THAN 1.5m AS PER THE MINES ACT 1958. WORKSAFE VICTORIA TO BE CONTACTED 3 DAYS PRIOR TO EXCAVATION WORKS FOR TRENCHES GREATER THAN 1.5m

ISSUED FOR CONSTRUCTION

EXISTING LEGEND	
	PERMANENT SURVEY MARK
	SURVEY STATION
	TRAVERSE LINE
	ELECTRICITY CABLE
	GAS MAIN
	SEWER MAIN
	TELECOM CABLE
	WATER MAIN
	DRAINAGE LINE
	PROPERTY STORMWATER
	JUNCTION PIT
	GRATED PIT
	ELECTRICITY PIT
	ELECTRICITY POLE & LIGHT
	STAY ANCHOR
	TRAM POLE
	TRAM POLE & LIGHT
	TRAFFIC LIGHT
	TRAFFIC SIGNAL COVERS
	TRAFFIC SIGNAL BOX
	POST BOX
	BOLLARD
	SEWER VENT
	SEWER MANHOLE / 10
	FIRE PLUG
	FIRE HYDRANT
	WATER VALVE
	GAS VALVE
	TELECOM PIT
	TELECOM CABINET
	PUBLIC TELEPHONE
	LITTER BIN
	BENCH-SEAT

NUMBER	AMENDMENT DESCRIPTION	DATE	APPROVED BY
1	----	----	----
2	----	----	----
3	----	----	----
4	----	----	----
5	----	----	----

**STONNINGTON**  
 Engineering Department  
 DESIGN & PROJECT MANAGEMENT

**CITY OF STONNINGTON**  
 311 Glenferrie Road, Malvern, Victoria  
 PO Box 58, Malvern 3144 Tel 8290 1333

Initials	Date	CAD Reference
Designed NP	6/05/2021	CANTERBURY ROAD
Drawn NP	6/05/2021	File Reference TBA
Checked MS		
Approved		Level Datum A.H.D.
Infrastructure Manager	Date	Surveyor SURFCOAST
Client	Date	FB

**GARDINER CREEK SHARED PATH**  
 BETWEEN BURKE ROAD AND ELM ROAD,  
 GLEN IRIS  
 DETAIL PLAN 4

DRAWING NUMBER 2019-015  
 SHEET 5 OF 20

SCALE: H. as shown  
 V. as shown



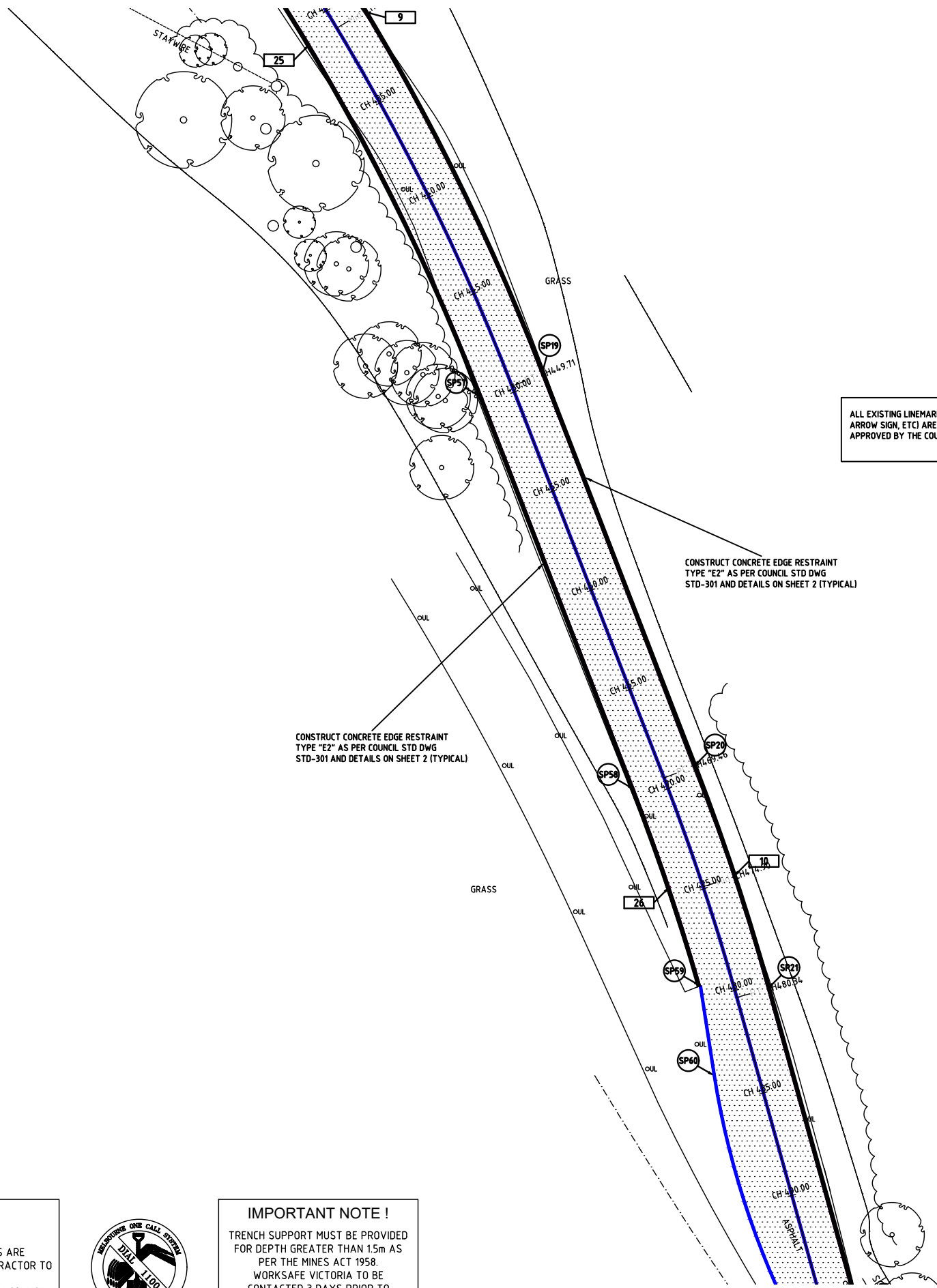

**LEGEND**

- RECONSTRUCT ASPHALT SHARED PATH AS PER COUNCIL STD DWG STD-413 AND DETAILS ON SHEET 2
- SETOUT POINT
- CURVE SETOUT

**WARNING AND DISCLAIMER  
BEWARE OF UNDERGROUND SERVICES**

THE LOCATION OF UNDERGROUND SERVICES PLOTTED IN THESE DRAWINGS ARE APPROXIMATE ONLY. THEREFORE IT IS THE RESPONSIBILITY OF THE CONTRACTOR TO PROVE THEIR EXACT POSITIONS ON SITE. FURTHERMORE, OTHER SERVICES MAY EXIST OF WHICH STONNINGTON CITY COUNCIL ARE UNAWARE. THEREFORE, THE INFORMATION PROVIDED NEEDS TO BE VERIFIED BY THE RELEVANT SERVICE AUTHORITIES



**IMPORTANT NOTE !**

TRENCH SUPPORT MUST BE PROVIDED FOR DEPTH GREATER THAN 1.5m AS PER THE MINES ACT 1958. WORKSAFE VICTORIA TO BE CONTACTED 3 DAYS PRIOR TO EXCAVATION WORKS FOR TRENCHES GREATER THAN 15m

**ISSUED FOR CONSTRUCTION**

EXISTING LEGEND	
	PERMANENT SURVEY MARK
	SURVEY STATION
	TRAVERSE LINE
	ELECTRICITY CABLE
	GAS MAIN
	SEWER MAIN
	TELECOM CABLE
	WATER MAIN
	DRAINAGE LINE
	PROPERTY STORMWATER
	JUNCTION PIT
	GRATED PIT
	ELECTRICITY PIT
	ELECTRICITY POLE
	ELECTRICITY POLE & LIGHT
	STAY ANCHOR
	TRAM POLE
	TRAM POLE & LIGHT
	TRAFFIC LIGHT
	TRAFFIC SIGNAL COVERS
	TRAFFIC SIGNAL BOX
	TRAFFIC / PARKING SIGN
	BOLLARD
	SEWER VENT
	SEWER MANHOLE / IO
	FIRE PLUG
	FIRE HYDRANT
	WATER VALVE
	GAS VALVE
	TELECOM PIT
	TELECOM CABINET
	PUBLIC TELEPHONE
	POST BOX
	LITTER BIN
	BENCH-SEAT

NUMBER	AMENDMENT DESCRIPTION	DATE	APPROVED BY
1	----	----	----
2	----	----	----
3	----	----	----
4	----	----	----
5	----	----	----

**STONNINGTON**  
Engineering Department  
DESIGN & PROJECT MANAGEMENT

**CITY OF STONNINGTON**  
311 Glenferrie Road, Malvern, Victoria  
PO Box 58, Malvern 3144 Tel 8290 1333

Initials	Date	CAD Reference
Designed NP	6/05/2021	CANTERBURY ROAD
Drawn NP	6/05/2021	File Reference TBA
Checked MS		
Approved		Level Datum A.H.D.
Infrastructure Manager	Date	Surveyor SURFCOAST
Client	Date	FB

**GARDINER CREEK SHARED PATH**  
BETWEEN BURKE ROAD AND ELM ROAD,  
GLEN IRIS  
DETAIL PLAN 5

SCALE: H. as shown  
V. as shown

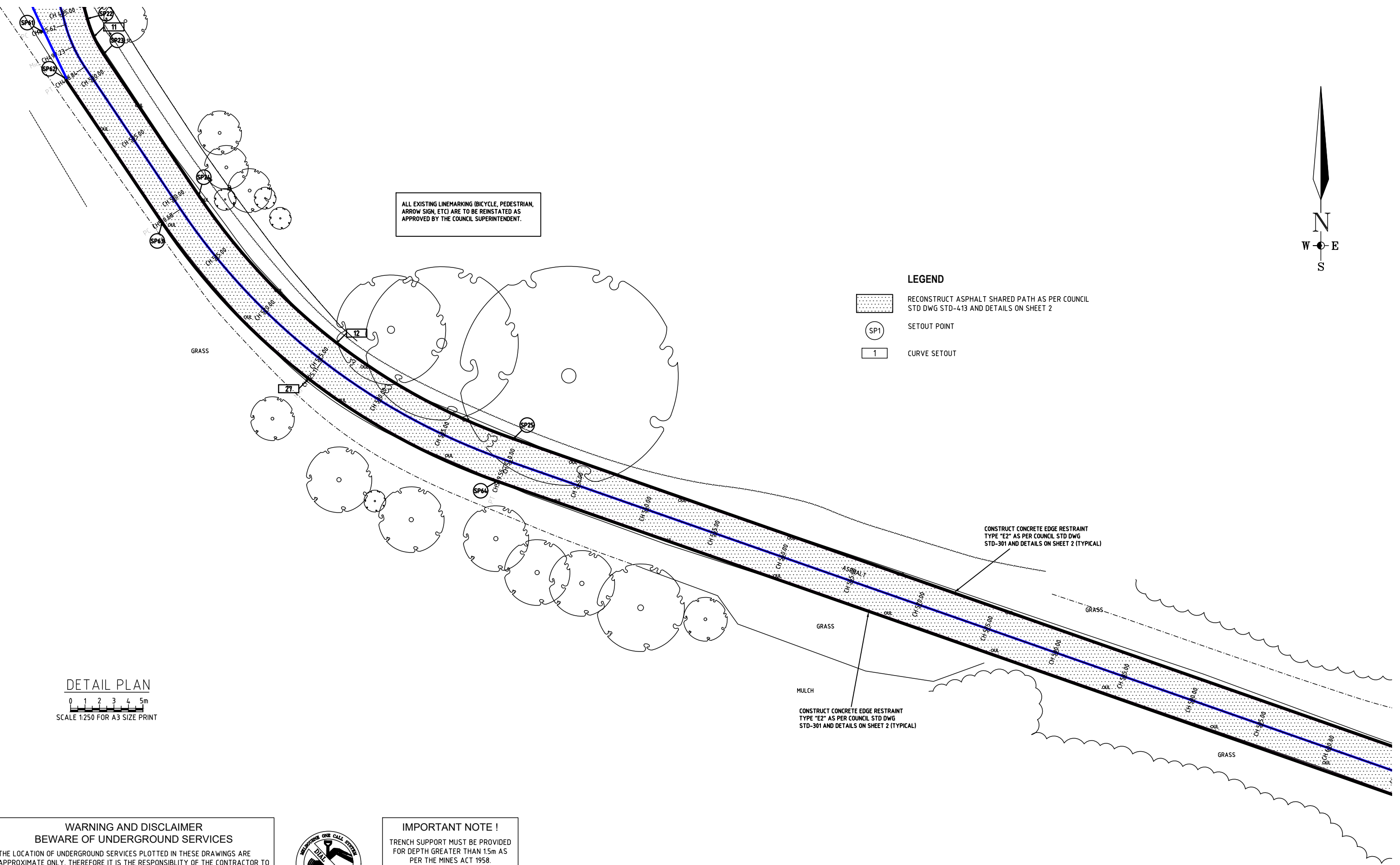

DRAWING NUMBER 2019-015  
Amendment No. [ ]  
SHEET 6 OF 20

DRAWING NUMBER 2019-015



ALL EXISTING LINEMARKING (BICYCLE, PEDESTRIAN, ARROW SIGN, ETC) ARE TO BE REINSTATED AS APPROVED BY THE COUNCIL SUPERINTENDENT.

**LEGEND**

-  RECONSTRUCT ASPHALT SHARED PATH AS PER COUNCIL STD DWG STD-413 AND DETAILS ON SHEET 2
-  SETOUT POINT
-  CURVE SETOUT

CONSTRUCT CONCRETE EDGE RESTRAINT TYPE "E2" AS PER COUNCIL STD DWG STD-301 AND DETAILS ON SHEET 2 (TYPICAL)

CONSTRUCT CONCRETE EDGE RESTRAINT TYPE "E2" AS PER COUNCIL STD DWG STD-301 AND DETAILS ON SHEET 2 (TYPICAL)

**DETAIL PLAN**



**WARNING AND DISCLAIMER  
BEWARE OF UNDERGROUND SERVICES**





















THE LOCATION OF UNDERGROUND SERVICES PLOTTED IN THESE DRAWINGS ARE APPROXIMATE ONLY. THEREFORE IT IS THE RESPONSIBILITY OF THE CONTRACTOR TO PROVE THEIR EXACT POSITIONS ON SITE. FURTHERMORE, OTHER SERVICES MAY EXIST OF WHICH STONNINGTON CITY COUNCIL ARE UNAWARE. THEREFORE, THE INFORMATION PROVIDED NEEDS TO BE VERIFIED BY THE RELEVANT SERVICE AUTHORITIES



**IMPORTANT NOTE !**

TRENCH SUPPORT MUST BE PROVIDED FOR DEPTH GREATER THAN 1.5m AS PER THE MINES ACT 1958. WORKSAFE VICTORIA TO BE CONTACTED 3 DAYS PRIOR TO EXCAVATION WORKS FOR TRENCHES GREATER THAN 1.5m

ISSUED FOR CONSTRUCTION

EXISTING LEGEND	
	PERMANENT SURVEY MARK
	SURVEY STATION
	ELECTRICITY CABLE
	GAS MAIN
	SEWER MAIN
	TELECOM CABLE
	WATER MAIN
	DRAINAGE LINE
	PROPERTY STORMWATER
	JUNCTION PIT
	GRATED PIT
	ELECTRICITY PIT
	ELECTRICITY POLE & LIGHT
	STAY ANCHOR
	TRAM POLE
	TRAM POLE & LIGHT
	TRAFFIC LIGHT
	TRAFFIC SIGNAL COVERS
	TRAFFIC SIGNAL BOX
	TRAFFIC / PARKING SIGN
	BOLLARD
	SEWER VENT
	SEWER MANHOLE / IO
	FIRE PLUG
	FIRE HYDRANT
	WATER VALVE
	GAS VALVE
	TELECOM PIT
	TELECOM CABINET
	PUBLIC TELEPHONE
	POST BOX
	LITTER BIN
	BENCH-SEAT

NUMBER	AMENDMENT DESCRIPTION	DATE	APPROVED BY
1	----	----	----
2	----	----	----
3	----	----	----
4	----	----	----
5	----	----	----

**STONNINGTON**  
Engineering Department  
DESIGN & PROJECT MANAGEMENT

**CITY OF STONNINGTON**  
311 Glenferrie Road, Malvern, Victoria  
PO Box 58, Malvern 3144 Tel 8290 1333

Initials	Date	CAD Reference
Designed NP	6/05/2021	CANTERBURY ROAD
Drawn NP	6/05/2021	File Reference TBA
Checked MS		
Approved		Level Datum A.H.D.
Infrastructure Manager	Date	Surveyor SURFCOAST
Client	Date	FB

**GARDINER CREEK SHARED PATH**  
BETWEEN BURKE ROAD AND ELM ROAD,  
GLEN IRIS  
DETAIL PLAN 6

DRAWING NUMBER 2019-015  
Amendment No. 

--	--	--

 SHEET 7 OF 20

SCALE: H. as shown  
V. as shown

DRAWING NUMBER 2019-015

GARDINERS CREEK

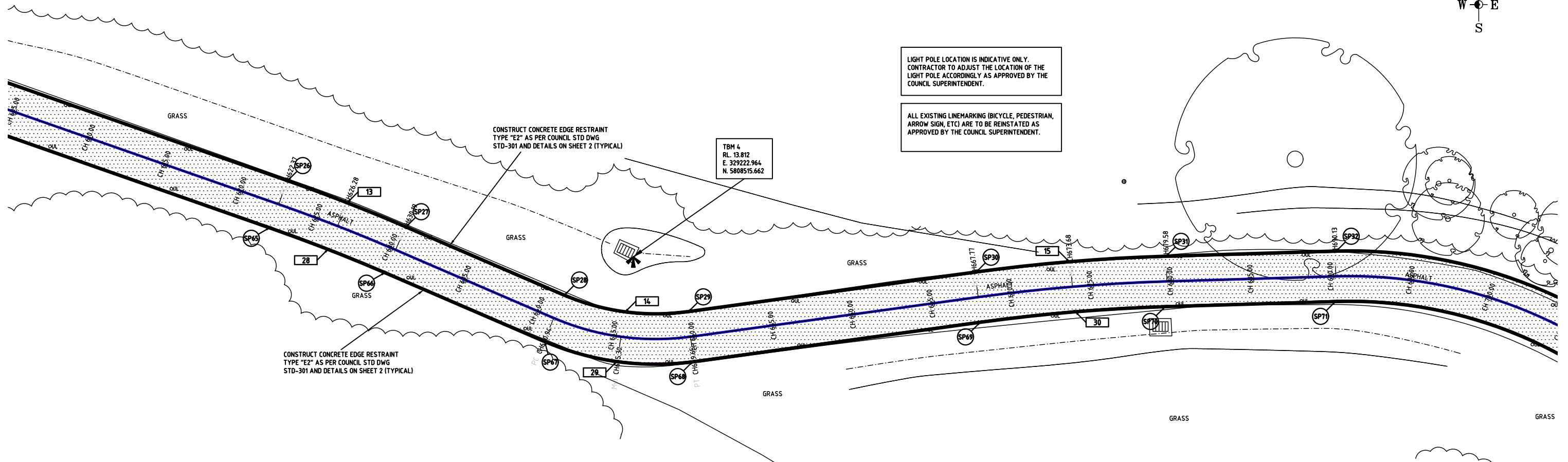

LIGHT POLE LOCATION IS INDICATIVE ONLY. CONTRACTOR TO ADJUST THE LOCATION OF THE LIGHT POLE ACCORDINGLY AS APPROVED BY THE COUNCIL SUPERINTENDENT.

ALL EXISTING LINEMARKING (BICYCLE, PEDESTRIAN, ARROW SIGN, ETC) ARE TO BE REINSTATED AS APPROVED BY THE COUNCIL SUPERINTENDENT.



LEGEND

- RECONSTRUCT ASPHALT SHARED PATH AS PER COUNCIL STD DWG STD-413 AND DETAILS ON SHEET 2
- SETOUT POINT
- CURVE SETOUT

**WARNING AND DISCLAIMER**  
**BEWARE OF UNDERGROUND SERVICES**  
 THE LOCATION OF UNDERGROUND SERVICES PLOTTED IN THESE DRAWINGS ARE APPROXIMATE ONLY. THEREFORE IT IS THE RESPONSIBILITY OF THE CONTRACTOR TO PROVE THEIR EXACT POSITIONS ON SITE. FURTHERMORE, OTHER SERVICES MAY EXIST OF WHICH STONNINGTON CITY COUNCIL ARE UNAWARE. THEREFORE, THE INFORMATION PROVIDED NEEDS TO BE VERIFIED BY THE RELEVANT SERVICE AUTHORITIES



**IMPORTANT NOTE !**  
 TRENCH SUPPORT MUST BE PROVIDED FOR DEPTH GREATER THAN 1.5m AS PER THE MINES ACT 1958. WORKSAFE VICTORIA TO BE CONTACTED 3 DAYS PRIOR TO EXCAVATION WORKS FOR TRENCHES GREATER THAN 15m

ISSUED FOR CONSTRUCTION

EXISTING LEGEND	
	PERMANENT SURVEY MARK
	SURVEY STATION
	TRAVERSE LINE
	ELECTRICITY CABLE
	GAS MAIN
	SEWER MAIN
	TELECOM CABLE
	WATER MAIN
	DRAINAGE LINE
	PROPERTY STORMWATER
	JUNCTION PIT
	GRATED PIT
	ELECTRICITY PIT
	ELECTRICITY POLE & LIGHT
	STAY ANCHOR
	TRAM POLE
	TRAM POLE & LIGHT
	TRAFFIC LIGHT
	TRAFFIC SIGNAL COVERS
	TRAFFIC SIGNAL BOX
	TRAFFIC / PARKING SIGN
	BOLLARD
	SEWER VENT
	SEWER MANHOLE / IO
	FIRE PLUG
	FIRE HYDRANT
	WATER VALVE
	GAS VALVE
	TELECOM PIT
	TELECOM CABINET
	PUBLIC TELEPHONE
	POST BOX
	LITTER BIN
	BENCH-SEAT

NUMBER	AMENDMENT DESCRIPTION	DATE	APPROVED BY
1	----	----	----
2	----	----	----
3	----	----	----
4	----	----	----
5	----	----	----

**STONNINGTON**  
 Engineering Department  
 DESIGN & PROJECT MANAGEMENT

**CITY OF STONNINGTON**  
 311 Glenferrie Road, Malvern, Victoria  
 PO Box 58, Malvern 3144 Tel 8290 1333

Initials	Date	CAD Reference
Designed NP	6/05/2021	CANTERBURY ROAD
Drawn NP	6/05/2021	File Reference
Checked MS		TBA
Approved		Level Datum A.H.D.
Infrastructure Manager	Date	Surveyor SURFCOAST
Client	Date	FB

**GARDINER CREEK SHARED PATH**  
 BETWEEN BURKE ROAD AND ELM ROAD,  
 GLEN IRIS  
 DETAIL PLAN 7

SCALE: H. as shown  
 V. as shown

DRAWING NUMBER: 2019-015  
 Amendment No. [ ]  
 SHEET 8 OF 20

DRAWING NUMBER: 2019-015

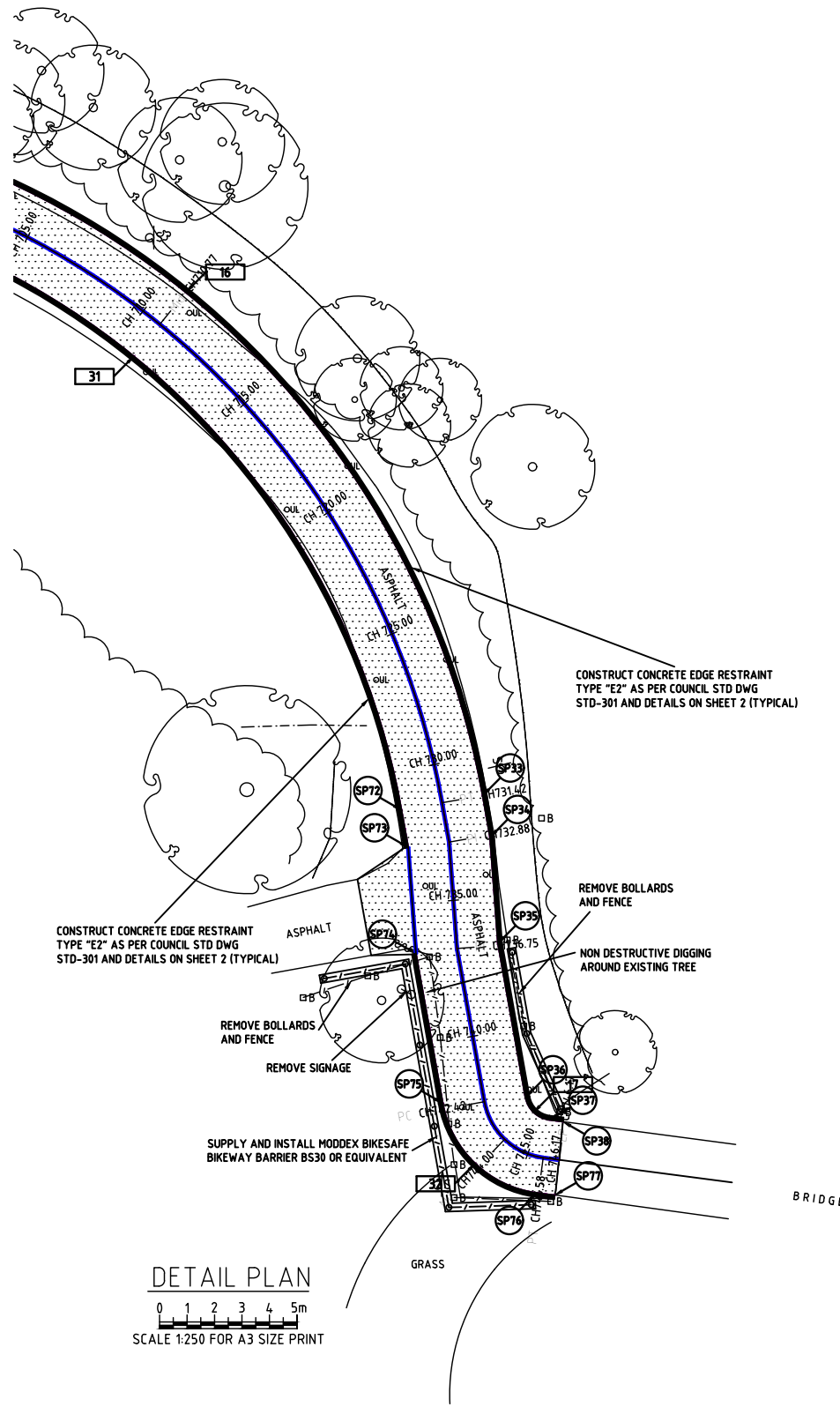

LIGHT POLE LOCATION IS INDICATIVE ONLY. CONTRACTOR TO ADJUST THE LOCATION OF THE LIGHT POLE ACCORDINGLY AS APPROVED BY THE COUNCIL SUPERINTENDENT.

ALL EXISTING LINEMARKING (BICYCLE, PEDESTRIAN, ARROW SIGN, ETC) ARE TO BE REINSTATED AS APPROVED BY THE COUNCIL SUPERINTENDENT.

CONSTRUCT CONCRETE EDGE RESTRAINT TYPE "E2" AS PER COUNCIL STD DWG STD-301 AND DETAILS ON SHEET 2 (TYPICAL)

CONSTRUCT CONCRETE EDGE RESTRAINT TYPE "E2" AS PER COUNCIL STD DWG STD-301 AND DETAILS ON SHEET 2 (TYPICAL)

REMOVE BOLLARDS AND FENCE

NON DESTRUCTIVE DIGGING AROUND EXISTING TREE

REMOVE BOLLARDS AND FENCE



REMOVE SIGNAGE

SUPPLY AND INSTALL MODEX BIKESAFE BIKEWAY BARRIER BS30 OR EQUIVALENT

BRIDGE

GRASS

**LEGEND**

-  RECONSTRUCT ASPHALT SHARED PATH AS PER COUNCIL STD DWG STD-413 AND DETAILS ON SHEET 2
-  SETOUT POINT
-  CURVE SETOUT



**WARNING AND DISCLAIMER**  
**BEWARE OF UNDERGROUND SERVICES**  
 THE LOCATION OF UNDERGROUND SERVICES PLOTTED IN THESE DRAWINGS ARE APPROXIMATE ONLY. THEREFORE IT IS THE RESPONSIBILITY OF THE CONTRACTOR TO PROVE THEIR EXACT POSITIONS ON SITE. FURTHERMORE, OTHER SERVICES MAY EXIST OF WHICH STONNINGTON CITY COUNCIL ARE UNAWARE. THEREFORE, THE INFORMATION PROVIDED NEEDS TO BE VERIFIED BY THE RELEVANT SERVICE AUTHORITIES



**IMPORTANT NOTE !**  
 TRENCH SUPPORT MUST BE PROVIDED FOR DEPTH GREATER THAN 1.5m AS PER THE MINES ACT 1958. WORKSAFE VICTORIA TO BE CONTACTED 3 DAYS PRIOR TO EXCAVATION WORKS FOR TRENCHES GREATER THAN 15m

ISSUED FOR CONSTRUCTION

EXISTING LEGEND		AMENDMENT DESCRIPTION		DATE	APPROVED BY
	SURVEY STATION	1	----	----	----
	TRAVERSE LINE	2	----	----	----
	ELECTRICITY CABLE	3	----	----	----
	GAS MAIN	4	----	----	----
	SEWER MAIN	5	----	----	----
	WATER MAIN				
	DRAINAGE LINE				
	PROPERTY STORMWATER				
	JUNCTION PIT				
	GRADED PIT				
	ELECTRICITY PIT				
	ELECTRICITY POLE & LIGHT				
	STAY ANCHOR				
	TRAM POLE				
	TRAM POLE & LIGHT				
	TRAFFIC LIGHT				
	TRAFFIC SIGNAL COVERS				
	TRAFFIC SIGNAL BOX				
	TRAFFIC / PARKING SIGN				
	BOLLARD				
	SEWER VENT				
	SEWER MANHOLE / IO				
	FIRE PLUG				
	FIRE HYDRANT				
	WATER VALVE				
	GAS VALVE				
	TELECOM PIT				
	TELECOM CABINET				
	PUBLIC TELEPHONE				
	POST BOX				
	LITTER BIN				
	BENCH-SEAT				

**STONNINGTON**  
 Engineering Department  
 DESIGN & PROJECT MANAGEMENT



**CITY OF STONNINGTON**  
 311 Glenferrie Road, Malvern, Victoria  
 PO Box 58, Malvern 3144 Tel 8290 1333



Initials	Date	CAD Reference
Designed NP	6/05/2021	CANTERBURY ROAD
Drawn NP	6/05/2021	File Reference TBA
Checked MS		
Approved		Level Datum A.H.D.
Infrastructure Manager	Date	Surveyor SURFCOAST
Client	Date	FB

**GARDINER CREEK SHARED PATH**  
 BETWEEN BURKE ROAD AND ELM ROAD,  
 GLEN IRIS  
 DETAIL PLAN 8

SCALE: H. as shown	DRAWING NUMBER	Amendment No.	SHEET
V. as shown	2019-015		9 OF 20

DRAWING NUMBER 2019-015