

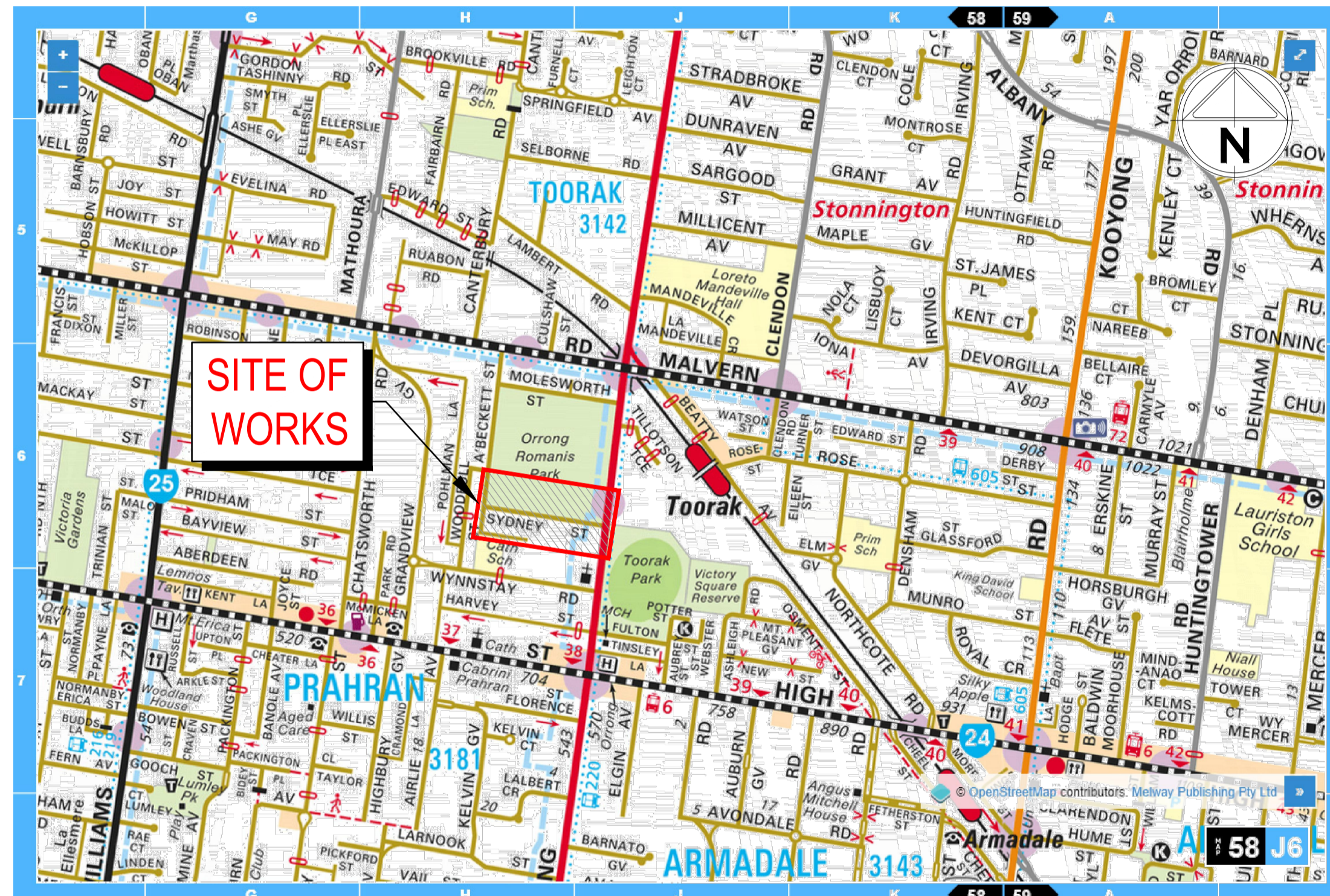

# Orrong Park Tennis Centre COURT & FLOODLIGHTING UPGRADE

STONNINGTON CITY COUNCIL  
TENDER



LOCALITY PLAN  
NOT TO SCALE

## SHEET INDEX

SHEET NO.	VERSION	DESCRIPTION
1	T3	LOCALITY PLAN AND DRAWING INDEX
2	T2	GENERAL NOTES
3	T2	EXISTING CONDITIONS PLAN
4	T2	DEMOLITION PLAN
5	T2	DETAIL PLAN
6	T2	DRAINAGE PLAN
7	T2	FENCE PLAN
8	T2	EARTHWORKS PLAN
9	T2	SITE ACCESS & TEMPORARY WORKS PLAN
10	T2	COURT SECTIONS
11	T3	STANDARD DETAILS - 1
12	T2	STANDARD DETAILS - 2

REV.	AMENDMENTS	APP'D	DATE
T3	INDEX UPDATED	BRG	03.05.2021
T2	NETBALL COURT AMENDMENT	BRG	27.10.2020
T1	ISSUED FOR TENDER	BRG	28.02.2020

© 2015 LD Eng Pty Ltd  
FILE: J11265\_Workspace\del\AJM\EL\_SQ11123900\_583PM2 DESIGN\G01 DESIGN\CAD\123900-SG1-CS.dwg LAYOUT: SG1-01 PLOTTED BY: Brent Gordon PLOT DATE: 3/5/2021 9:42 AM

**WARNING**  
BEWARE OF UNDERGROUND/OVERHEAD SERVICES  
THE LOCATION OF SERVICES ARE APPROXIMATE ONLY AND THEIR EXACT POSITION SHOULD BE PROVEN ON SITE. NO GUARANTEE IS GIVEN THAT ALL EXISTING SERVICES ARE SHOWN. SPECIAL CONSIDERATION SHOULD BE GIVEN TO CONSTRUCTION PROCEDURES UNDER OVERHEAD ELECTRICITY TRANSMISSION LINES.



Scale

NOT TO SCALE

PM	B. GORDON
DESIGNED	31.10.2019
CHECKED	N.KEOGH
	05.11.2019
AUTHORISED	N.MIRATANA
	05.11.2019
MELWAYS	B. GORDON
CLIENT REF:	58 J6
STATUS:	

**ORRONG PARK TENNIS CENTRE  
COURT & FLOODLIGHTING UPGRADE**  
STONNINGTON CITY COUNCIL  
LOCALITY PLAN AND DRAWING INDEX

TENDER 123900SG01

SHEET No. 1 OF 13  
REV. T3

**1. GENERAL NOTES:**

- 1.1. ALL WORKS TO BE CARRIED OUT IN ACCORDANCE WITH THE CONDITIONS OF CONTRACT, THE ROAD & DRAINAGE SPECIFICATION, APPROVED MUNICIPALITY SPECIFICATIONS AND STANDARD DRAWINGS AND TO THE SATISFACTION OF SUPERINTENDENT AND THE CITY ENGINEER OR HIS REPRESENTATIVE.
- 1.2. COUNCIL TO BE NOTIFIED SEVEN (7) CLEAR WORKING DAYS PRIOR TO THE COMMENCEMENT OF WORKS WITH A PRECOMMENCEMENT MEETING BEING HELD BETWEEN COUNCIL AND THE CONTRACTOR, BEFORE WORKS COMMENCE. A SITE MANAGEMENT PLAN IS TO BE SUBMITTED PRIOR TO COMMENCEMENT OF WORKS.
- 1.3. PRIOR TO COMMENCEMENT OF THE WORKS, THE CONTRACTOR SHALL PROVIDE THE FOLLOWING INFORMATION:
  - 1.3.1. SOURCE OF QUARRY MATERIAL
  - 1.3.2. N.A.T.A. APPROVED TESTS RESULTS FOR THE F.C.R. THAT IS TO BE USED
  - 1.3.3. IF THE SOURCE OF THE QUARRY MATERIAL IS CHANGED DURING THE COURSE OF THE WORKS, THEN NEW TEST RESULTS SHALL BE PROVIDED.
- 1.4. PRIOR TO COMMENCEMENT OF WORKS ON SITE, THE CONTRACTOR MUST ENSURE THAT ALL MATTERS RELATING TO THE WORK SAFE HEALTH AND SAFETY ACT, HAVE BEEN AND WILL BE COMPLIED WITH.
- 1.5. ON COMMENCEMENT OF CONSTRUCTION WORKS, THE CONTRACTOR MUST COMPLY WITH THE RECOMMENDATIONS OF THE ENVIRONMENT PROTECTION AUTHORITY PUBLICATION "CONSTRUCTION TECHNIQUES FOR SEDIMENT POLLUTION CONTROL." APPROPRIATE SILTATION CONTROL IS TO BE MAINTAINED THROUGHOUT THE CONSTRUCTION AND MAINTENANCE PERIOD OF THE WORKS.
- 1.6. THE LOCATION OF EXISTING SERVICES SHOULD BE DETERMINED BY THE CONTRACTOR PRIOR TO COMMENCING ANY EXCAVATION BY CONTACTING ALL LOCAL SERVICE AUTHORITIES. ANY EXISTING SERVICES SHOWN ON THESE DRAWINGS ARE OFFERED AS A GUIDE ONLY AND ARE NOT GUARANTEED AS CORRECT.
- 1.7. ANY BUILDINGS, TROUGHS, FENCES AND OTHER STRUCTURES ON SITE ARE TO BE REMOVED AS DIRECTED BY THE ENGINEER. THE COST OF REMOVAL IS TO BE INCLUDED IN THE OVERALL EARTHWORKS FIGURE UNLESS A SPECIFIC ITEM FOR REMOVAL IS DENOTED IN THE SCHEDULE.
- 1.8. ALL TEMPORARY WARNING SIGNS USED DURING CONSTRUCTION SHALL BE IN ACCORDANCE WITH AS 1742-3.
- 1.9. ALL EXISTING ASSETS AFFECTED BY THE WORKS; EG SIGNS, VEHICLE CROSSINGS, FOOTPATHS, KERB AND LINEMARKING SHALL BE REINSTATED BY THE CONTRACTOR PRIOR TO THE COMPLETION OF THE WORKS TO THE SATISFACTION OF THE CHIEF EXECUTIVE OFFICER AND/OR THEIR REPRESENTATIVE.
- 1.10. THE CONTRACTOR SHALL ENSURE ALL AREAS DRAIN WITH A MINIMUM FALL OF 1% (1:100) GRADE TO OUTLETS UNLESS INDICATED OTHERWISE OR APPROVED BY THE SUPERINTENDENT. NO WORKS SHALL CAUSE PONDING OF STORMWATER ON UPSTREAM PROPERTIES OR CONCENTRATED RUNOFF ONTO DOWNSTREAM PROPERTIES.
- 1.11. DURING CONSTRUCTION THE CONTRACTOR SHALL BE RESPONSIBLE FOR MAINTAINING ANY STRUCTURE IN A SUITABLE CONDITION AND ENSURING NO PART SHALL BE OVER STRESSED UNDER CONSTRUCTION ACTIVITIES.
- 1.12. WORKMANSHIP AND MATERIALS ARE TO BE IN ACCORDANCE WITH THE RELEVANT AUSTRALIAN STANDARD CODES INCLUDING AMENDMENTS, AND LOCAL STATUTORY AUTHORITIES, EXCEPT WHERE VARIED BY THE CONTRACT DOCUMENTS.
- 1.13. THE CONTRACTOR IS TO EMPLOY A QUALIFIED GEOTECHNICAL ENGINEER AS REQUIRED FOR ALL GEOTECHNICAL ASPECTS OF THE BUILDING WORKS. REFER ALSO TO THE GEOTECHNICAL REPORT FOR THIS PROJECT.
- 1.14. AT THE COMPLETION OF ALL WORKS, ALL RUBBISH, DEBRIS AND SURPLUS SPOIL SHALL BE REMOVED AND THE SITE SHALL BE CLEARED TO THE SATISFACTION OF THE CHIEF EXECUTIVE OFFICER AND/OR THEIR REPRESENTATIVE.

**2. SURVEY & SETOUT:**

- 2.1. ALL LEVELS ARE TO AUSTRALIAN HEIGHT DATUM AND ALL COORDINATES ARE MGA94, ZONE 55.
- 2.2. CONTRACTOR MUST CERTIFY ALL DIMENSIONS AND EXISTING LEVELS ONSITE PRIOR TO COMMENCEMENT OF WORKS.
- 2.3. ALL DIMENSIONS ARE IN METRES UNLESS NOTED OTHERWISE.
- 2.4. DIMENSIONS MUST NOT BE SCALED FROM DRAWINGS.
- 2.5. ALL CHAINAGES REFER TO CENTRELINES
- 2.6. TBM'S TO BE RE-ESTABLISHED BY THE LICENSED SURVEYOR IF FOUND TO BE MISSING AT THE COMMENCEMENT OF CONSTRUCTION. THE CONTRACTOR WILL BE RESPONSIBLE FOR CARE AND MAINTENANCE OF T.B.M.'S THEREAFTER.
- 2.7. ALL EXISTING SURFACE LEVELS SHOWN ON THE ENGINEERING DRAWINGS HAVE BEEN INTERPOLATED FROM A DIGITAL TERRAIN MODEL. THESE LEVELS HAVE BEEN USED AS THE BASIS FOR ALL ENGINEERING DESIGN AND DETERMINATION OF QUANTITIES AND ARE ACCURATE TO WITHIN ±0.05m.
- 2.8. SETOUT DRAWING IN DWG FORMAT WILL BE PROVIDED FOR A ALL SETOUT OF DRAINAGE/KERBS/FIELDS OF PLAY/FOOTPATHS etc.

**3. EARTHWORKS:**

- 3.1. THE CONTRACTOR IS RESPONSIBLE FOR ENSURING THAT ALL IMPORTED FILL MATERIAL, INCLUDING TOPSOIL, SATISFIES THE DESCRIPTION FOR CLEAN FILL MATERIAL IN EPA BULLETIN PUBLICATION NO 448 (SEPT '95) AND SUBSEQUENT REVISIONS. THE CONTRACTOR SHALL IF REQUIRED PROVIDE VERIFICATION INCLUDING TEST CERTIFICATES TO THE CHIEF EXECUTIVE OFFICER AND/OR THEIR REPRESENTATIVE.
- 3.2. THE DISPOSAL SITE FOR SPOIL REMOVAL FROM SITE AND TRUCK ROUTE IS TO BE SUBMITTED TO AND APPROVED BY COUNCIL AND/OR THEIR REPRESENTATIVE IN WRITING PRIOR TO THE COMMENCEMENT OF ANY WORKS
- 3.3. ALL BATTERS SHALL BE 1 IN 6, UNLESS OTHERWISE SHOWN.
- 3.4. FILL OR STOCKPILING OF MATERIAL IS TO BE PLACED ON AS DIRECTED BY THE SUPERINTENDENT.
- 3.5. ALL EXISTING SWALES ARE TO BE BREACHED, DRAINED, DESLUDGED AND SHALL BE EXCAVATED TO A CLEAN FIRM BASE. THE SURFACE SHALL BE INSPECTED APPROVED AND LEVELED BY THE ENGINEER PRIOR TO COMMENCEMENT OF FILLING. THE FILL SHALL BE APPROVED SELECTED ON SITE MATERIAL OR APPROVED IMPORTED MATERIAL. THE FILL SHALL BE PLACED UNDER CONTROLLED MOISTURE CONDITIONS IN ACCORDANCE WITH THE SPECIFICATION
- 3.6. NO BLASTING TO BE CARRIED OUT WITHIN THE MUNICIPALITY WITHOUT OBTAINING COUNCILS SPECIAL PERMISSION. RESTRICTED BLASTING WITHIN 20 METRES OF WATER MAINS AND WITHIN 6 METRES OF TELSTRA CONDUITS
- 3.7. ALL EXCAVATED ROCK TO BE REMOVED AND DISPOSED OFF SITE.

**4. TREE PROTECTION ZONES:**

- 4.1. ALL TREES AND SHRUBS ARE TO BE RETAINED UNLESS OTHERWISE SHOWN. IF ROAD AND DRAINAGE CONSTRUCTION NECESSITATES THEIR REMOVAL, WRITTEN PERMISSION MUST BE OBTAINED FROM THE ENGINEER.
- 4.2. TREES ON COUNCIL RESERVES TO BE PROTECTED WITH APPROPRIATE EXCLUSION FENCING PRIOR TO COMMENCEMENT OF ANY WORKS

**5. SERVICES & TRENCHING:**

- 5.1. BEFORE COMMENCING WORK ON THE TRENCHES IN EXCESS OF 1.5 METRES DEEP, NOTICE OF SUCH PROPOSAL IS TO BE SENT TO THE PRINCIPAL MINING INSPECTOR, VICTORIA WORKCOVER AUTHORITY IN ACCORDANCE WITH THE MINES ACT 1958 & O.H.&S. ACT 1985. A FOREMAN, QUALIFIED AS A NOMINATED PERMITTED MINES MANAGER, MUST BE IN ATTENDANCE AT ALL TIMES DURING SUCH EXCAVATION.
- 5.2. WHERE WORKS ARE IN THE VICINITY OF EXISTING SERVICES, THESE SERVICES ARE TO BE LOCATED AND EXPOSED/PROVED PRIOR TO COMMENCEMENT OF WORKS, AND THE RELEVANT AUTHORITIES NOTIFIED SEVEN (7) CLEAR DAYS PRIOR TO THE COMMENCEMENT OF THE WORKS.
- 5.3. ALL SERVICE TRENCHES UNDER PAVEMENTS TO BE BACKFILLED WITH CLASS 2 CRUSHED ROCK. SERVICE TRENCHES LESS THAN 750mm BEHIND PARKING BAYS ARE ALSO TO BE BACKFILLED WITH COMPACTED CLASS 2 CRUSHED ROCK.
- 5.4. WATER CONDUITS ARE TO THE FOLLOWING MINIMUM COVER TO FINISHED SURFACE LEVELS:
  - 5.4.1. PAVEMENT - 800mm
  - 5.4.2. VERGE, FOOTPATHS - 450mm
- 5.5. ALL SERVICE CONDUIT TRENCHES UNDER PAVEMENTS TO BE BACKFILLED WITH 2% CEMENT TREATED CRUSHED ROCK.
- 5.6. SERVICE CROSSING LOCATIONS SHALL BE MARKED ON KERBS IN ACCORDANCE WITH CITY OF STONNINGTON STANDARDS 303

**6. DRAINAGE NOTES:**

- 6.1. PITS GREATER THEN 1.0m DEEP TO BE FITTED WITH STEP IRONS.
- 6.2. STEP IRONS SHALL BE LOCATED DIRECTLY BELOW THE OPENING IN THE COVER AND DESIRABLY ON A WALL WITHOUT PIPE OPENINGS.
- 6.3. WHERE STEP IRON LADDER CHANGES FROM ONE WALL TO THE ADJACENT WALL, STEP IRON LADDERS TO OVERLAP BY 1200mm MINIMUM.
- 6.4. STEEL FOR STEP-IRONS SHALL BE STRUCTURAL GRADE 250 TO AS3679 PART.
- 6.5. STEP IRONS SHALL HAVE SHARP EDGES ROUNDED AND HOT DIP GALVANISED AFTER FABRICATION TO AS/NZS 4680.
- 6.6. PROPRIETARY POLYPROPYLENE STEP IRONS (OR APPROVED ALTERNATIVE) MAY BE USED. THESE SHALL BE INSTALLED ACCORDING TO THE MANUFACTURERS INSTRUCTIONS.
- 6.7. FOR PRECAST PITS, STEP IRONS SHALL BE LOAD TESTED TO AS4198/1994.
- 6.8. DRAINAGE PIPES IN ROADWAYS SHALL BE BACKFILLED WITH COMPACTED CLEAN, SHARP SAND TO 200MM ABOVE PIPE OBVERT. ADDITIONAL BACKFILL SHALL CONSIST OF A GRANULAR MATERIAL COMPACTED IN 200MM LAYERS.
- 6.9. CONCRETE STORMWATER PIPES TO BE CLASS "2" UNLESS NOTED OTHERWISE.
- 6.10. CONCRETE PITS GREATER THEN 1.0m DEEP TO BE REINFORCED.
- 6.11. 150-300mm DIA. UPVC PIPES TO BE SEWER GRADE WITH MINIMUM COVER OF 400mm UNDER PAVEMENTS.
- 6.12. PIT COVERS AND GRATES IN TRAFFICABLE PAVEMENT TO BE IN ACCORDANCE WITH AS3996 CLASS D "HEAVY DUTY".
- 6.13. PIT COVERS AND GRATES IN NON-TRAFFICABLE PAVEMENT TO BE IN ACCORDANCE WITH AS3996 CLASS C "LIGHT DUTY".

**7. CONCRETE WORKS:**

- 7.1. FOOTPATHS TO BE 75mm THICK N25 CONCRETE ON 50mm THICK 20mm NOMINAL SIZE CLASS 3 CRUSHED ROCK OR CLASS 2 CRUSHED CONCRETE MECHANICALLY COMPACTED IN ACCORDANCE WITH CITY OF STONNINGTON STANDARDS
- 7.2. KERB & CHANNEL TO BE IN ACCORDANCE WITH CITY OF STONNINGTON STANDARDS
- 7.3. ANY EXPOSED AGGREGATE CONCRETE WORKS TO BE ACHIEVED BY SANDBLASTING ONLY. WASHING AGGREGATE OFF WITH WATER IS NOT PERMITTED.
- 7.4. ALL NEW CONCRETE WORKS SHALL BE JOINED INTO ABUTTING EXISTING CONCRETE WITH 450mm LONG Y20 DOWEL BARS @ 600 CENTRES, UNLESS OTHERWISE SPECIFIED.
- 7.5. ALL WORKMANSHIP AND MATERIALS SHALL BE IN ACCORDANCE WITH AS3600 S.A.A. CONCRETE STRUCTURES.
- 7.6. CONCRETE SLUMP SHALL BE 80mm UNLESS STATED OTHERWISE.
- 7.7. CONCRETE TESTING SHALL BE IN ACCORDANCE WITH AS1379.

**8. UTILITY SERVICES:**

- 8.1. THE LOCATIONS OF UNDERGROUND SERVICES SHOWN ON DRAWINGS HAVE BEEN PLOTTED DETECTED BY UTILITY MAPPING. THE SERVICE INFORMATION HAS BEEN PREPARED ONLY TO FOR A SELECT AREA AND SERVICES MAY NOT BE SHOWN OUTSIDE THE AREA OF WORKS.
- 8.2. IT IS THE RESPONSIBILITY OF THE CONTRACTOR TO ESTABLISH THE LOCATION AND LEVEL OF ALL EXISTING SERVICES PRIOR TO COMMENCEMENT OF ANY WORK. ANY DISCREPANCIES SHALL BE REPORTED TO THE SUPERINTENDENT. CLEARANCES SHALL BE OBTAINED IN WRITING FROM THE RELEVANT SERVICE AUTHORITY.
- 8.3. CONTRACTORS SHALL TAKE DUE CARE WHEN EXCAVATING ON SITE INCLUDING HAND EXCAVATION WHERE NECESSARY.

**9. ELECTRICAL AND GAS SERVICES:**

- 9.1. A MINIMUM OF 30 DAYS PRIOR TO THE COMMENCEMENT OF EXCAVATION WORKS THE CONTRACTOR MUST CONTACT DIAL BEFORE YOU DIG.

T2	NETBALL COURT AMENDMENT	BRG	27.10.2020
T1	ISSUED FOR TENDER	BRG	28.02.2020
REV.	AMENDMENTS	APPD	DATE

© 2015 LD Eng Pty Ltd  
 FILE: J:\1265 - work\spacedata\ALMEL\SQL01\123900\_583PM02 DESIGN\G01 DESIGN\ACAD\123900-SG01-CS.dwg LAYOUT: SG01-02 PLOTTED BY: Nick Keogh PLOT DATE: 27/10/2020 2:31 PM



Level 1, 1-5 Mantilla Road  
 Notting Hill, Vic 3168  
 Ph: 03 9562 7424  
 ldeng.com.au

PM	B. GORDON
DESIGNED	31.10.2019
CHECKED	05.11.2019
AUTHORISED	05.11.2019
MELBURNS	B. GORDON
CLIENT REF:	58 JS
STATUS:	

**ORRONG PARK TENNIS CENTRE COURT & FLOODLIGHTING UPGRADE**  
 STONNINGTON CITY COUNCIL  
 GENERAL NOTES

TENDER 123900SG02

REV. T2



LEGEND	
	EXISTING WATER MAIN
	EXISTING RECYCLED WATER MAIN
	EXISTING UNDERGROUND ELECTRICITY
	EXISTING OVERHEAD ELEC & POLE
	EXISTING TELSTRA & SERVICE PIT
	EXISTING OPTIC FIBRE
	EXISTING GAS MAIN
	EXISTING FENCE
	EXISTING SEWER & MANHOLE
	EXISTING SEWER RISING MAIN
	EXISTING STORMWATER DRAIN & PIT
	EXISTING SURFACE CONTOUR MINOR
	EXISTING SURFACE CONTOUR MAJOR
	EXISTING TOP OF BATTER
	EXISTING TOE OF BATTER
	EXISTING KERB
	EXISTING FOOTPATH
	EXISTING SURFACE LEVEL
	EXISTING BUILDING
	EXISTING SIGN AND POST
	EXISTING PERMANENT SURVEY MARK
	EXISTING TREE TO BE RETAINED (SURVEYED CANOPY)

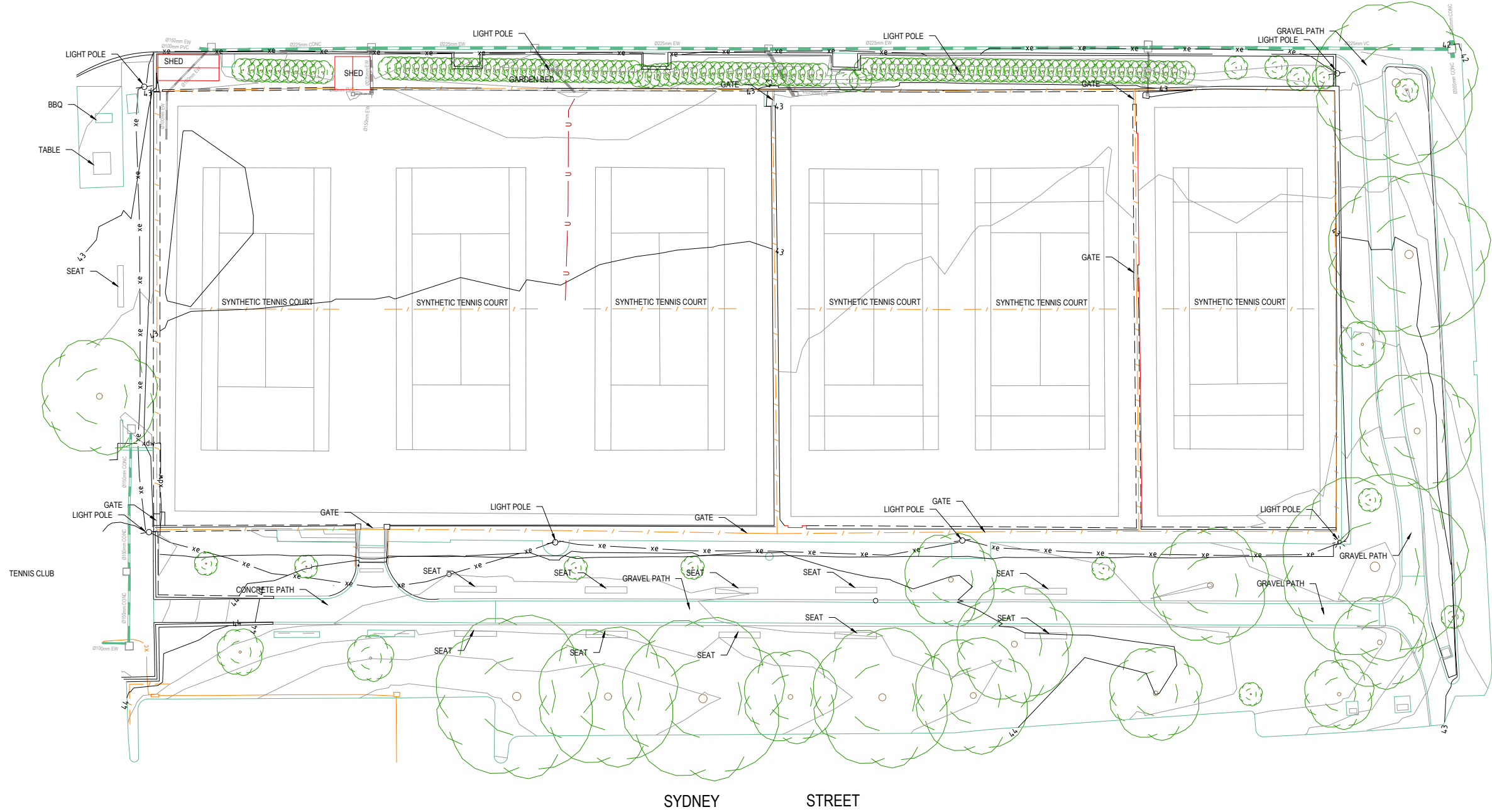

REV.	AMENDMENTS	APPD	DATE
T2	NETBALL COURT AMENDMENT	BRG	27.10.2020
T1	ISSUED FOR TENDER	BRG	28.02.2020

© 2015 LD Eng Pty Ltd  
 FILE: J:\12395\_workspace\del\ALMEL\_SQ\_01\123905\_SE3PM02\_DESIGN\G01\_DESIGN\ACAD\123905SG00.dwg LAYOUT: S02-01 PLOTTED BY: Nick Keogh PLOT DATE: 27/10/2020 2:31 PM



PM	B. GORDON
DESIGNED	31.10.2019
CHECKED	05.11.2019
AUTHORISED	05.11.2019
MELBAYS	05.11.2019
CLIENT REF:	58 JB

**ORRONG PARK TENNIS CENTRE COURT & FLOODLIGHTING UPGRADE**  
 STONNINGTON CITY COUNCIL  
 EXISTING CONDITIONS PLAN



**LEGEND**

- EXISTING SURFACE CONTOUR MINOR
- EXISTING SURFACE CONTOUR MAJOR
- EXISTING ROCK WALL
- EXISTING TOE OF BATTER
- EXISTING KERB
- EXISTING FOOTPATH
- EXISTING SURFACE LEVEL
- EXISTING BUILDING
- EXISTING TREE TO BE RETAINED (SURVEYED CANOPY)
- EXISTING TREE TO BE REMOVED
- AREA OF DEMOLITION

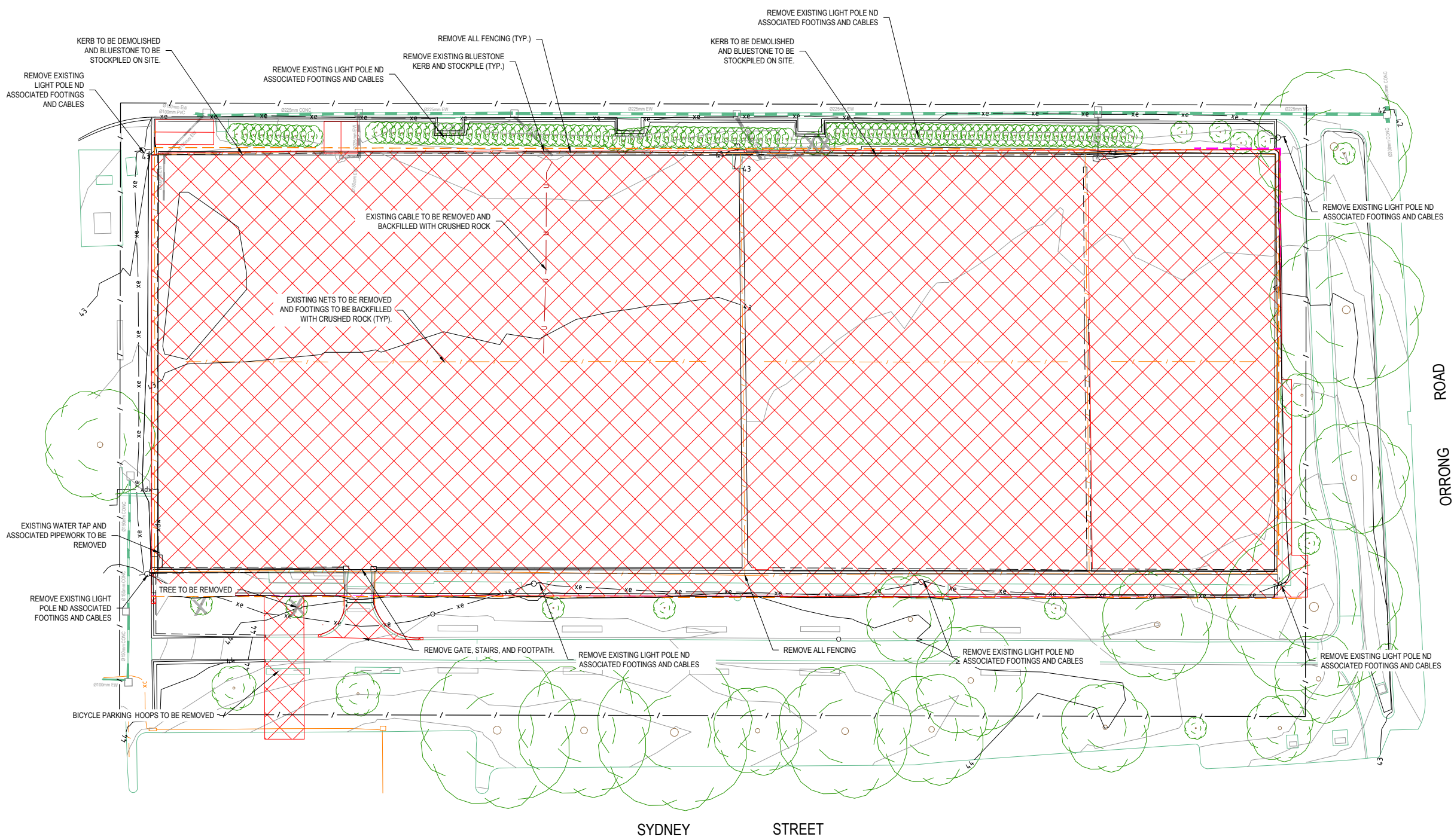

**TREE PROTECTION:**

BEFORE THE PROJECT (INCLUDING EXCAVATION AND DEMOLITION) COMMENCES, PROTECTION FENCING MUST BE AFFORDED TO ALL COUNCIL TREE ASSETS LOCATED WITHIN THE DESIGNATED WORK ZONE. FENCING MUST BE LOCATED AND COMPLY WITH AS 4970 -2009 - PROTECTION OF TREES ON DEVELOPMENT SITES. FENCING MUST BE INSPECTED AND APPROVED BY A COUNCIL ARBORIST PRIOR TO WORKS COMMENCING.

REV.	AMENDMENTS	APPD	DATE
T2	NETBALL COURT AMENDMENT	BRG	27.10.2020
T1	ISSUED FOR TENDER	BRG	28.02.2020

© 2015 LD Eng Pty Ltd  
 FILE: J:\12305\_workspace\client\ALMEL\SQL\01123900\_583PM22 DESIGN\G01 DESIGN\ACAD\123900SG00.dwg LAYOUT: SG2-02 PLOTTED BY: Nick Keogh PLOT DATE: 27/10/2020 2:31 PM



**LDeng**  
 Land Development Engineering  
 Level 1, 1-5 Mantilla Road  
 Notting Hill, Vic 3168  
 Ph: 03 9562 7424  
 ldeng.com.au



PM	B. GORDON
DESIGNED	31.10.2019
CHECKED	05.11.2019
AUTHORISED	05.11.2019
MELBURNS	58 JS
STATUS	

**ORRONG PARK TENNIS CENTRE COURT & FLOODLIGHTING UPGRADE**  
 STONNINGTON CITY COUNCIL  
 DEMOLITION PLAN



LEGEND	
	EXISTING WATER MAIN
	EXISTING RECYCLED WATER MAIN
	EXISTING UNDERGROUND ELECTRICITY
	EXISTING OVERHEAD ELEC & POLE
	EXISTING TELSTRA & SERVICE PIT
	EXISTING GAS MAIN
	EXISTING FENCE
	EXISTING STORMWATER DRAIN & PIT
	EXISTING SURFACE CONTOUR MINOR
	EXISTING SURFACE CONTOUR MAJOR
	EXISTING TOE OF BATTER
	EXISTING KERB
	EXISTING FOOTPATH
	EXISTING BUILDING
	KERB & CHANNEL + TYPE
	FIELD CHAINAGE
	FINISHED SURFACE CONTOUR MINOR
	FINISHED SURFACE CONTOUR MAJOR
	SLOTTED DRAINAGE CHANNEL
	PROPOSED STORMWATER DRAIN & PIT
	EXISTING TREE TO BE RETAINED (SURVEYED CANOPY)
	EXISTING TREE TO BE REMOVED
	TENNIS COURT PRINCIPLE PLAYING AREA
	TENNIS COURT TOTAL PLAYING AREA

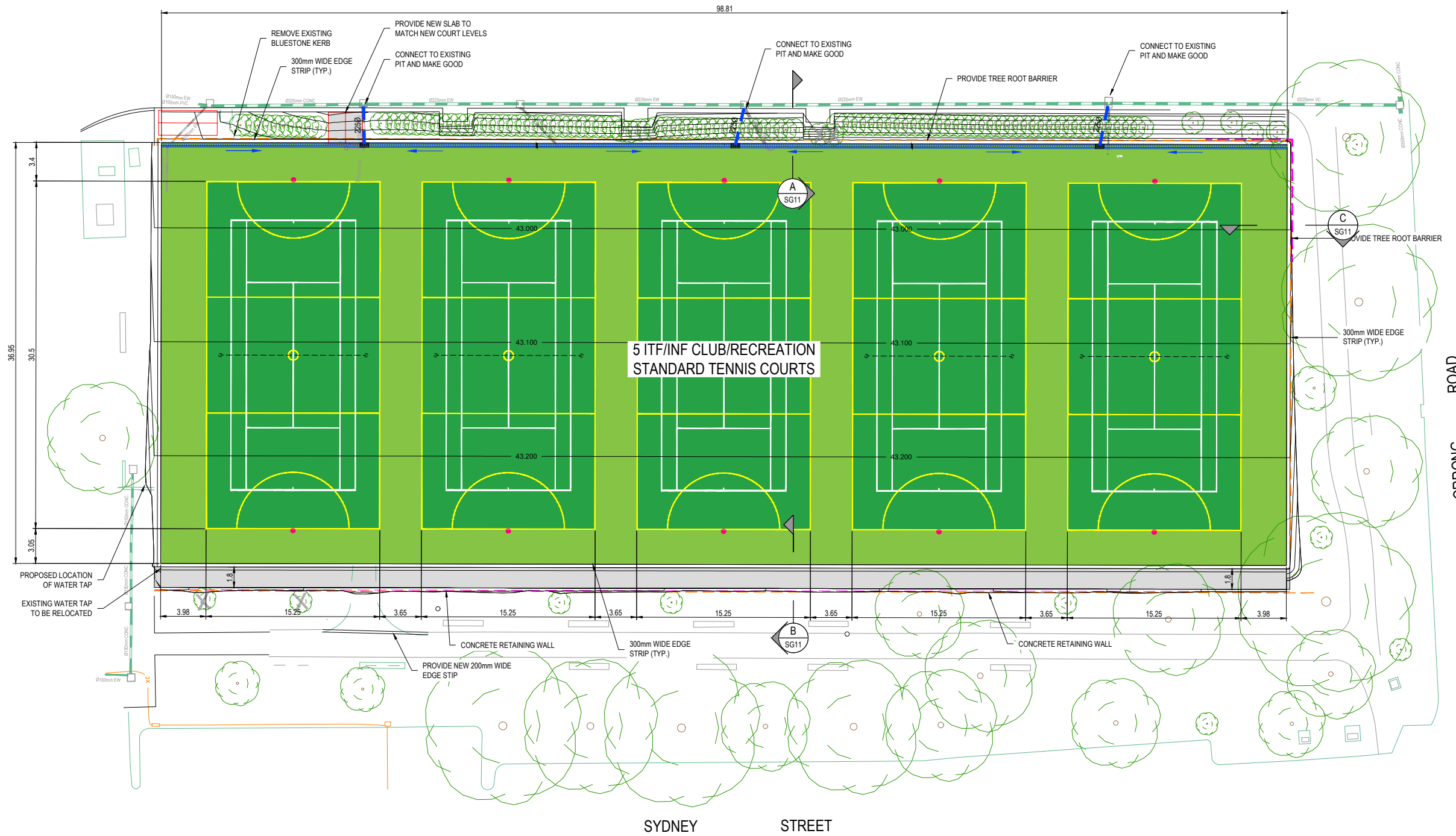

REV.	AMENDMENTS	APPD	DATE
T2	NETBALL COURT AMENDMENT	BRG	27.10.2020
T1	ISSUED FOR TENDER	BRG	28.02.2020

© 2015 LD Eng Pty Ltd  
 PLE: J11265\_workspace\ldeng\ALMEL\SQL01123900\_583PM02 DESIGN\G01 DESIGN\ACAD\123900SG00.dwg LAYOUT: SG2-03 PLOTTED BY: Nick Keogh PLOT DATE: 27/10/2020 2:31 PM



Scale 1:200, A1  
 Horizontal 0 2 4 6 8 10  
 Vertical 0 2 4 6 8 10

PM	B. GORDON
DESIGNED	31.10.2019
CHECKED	05.11.2019
AUTHORISED	05.11.2019
MELBWAYS	58.05
STATUS	

**ORRONG PARK TENNIS CENTRE COURT & FLOODLIGHTING UPGRADE**  
 STONNINGTON CITY COUNCIL  
 DETAIL PLAN

TENDER	123900SG05	SHEET No.	5 OF 13
REV.	T2		



**LEGEND**

- Ex 4500 EXISTING STORMWATER DRAIN & PIT
- 4500 PROPOSED STORMWATER DRAIN & PIT
- SLOTTED DRAINAGE CHANNEL

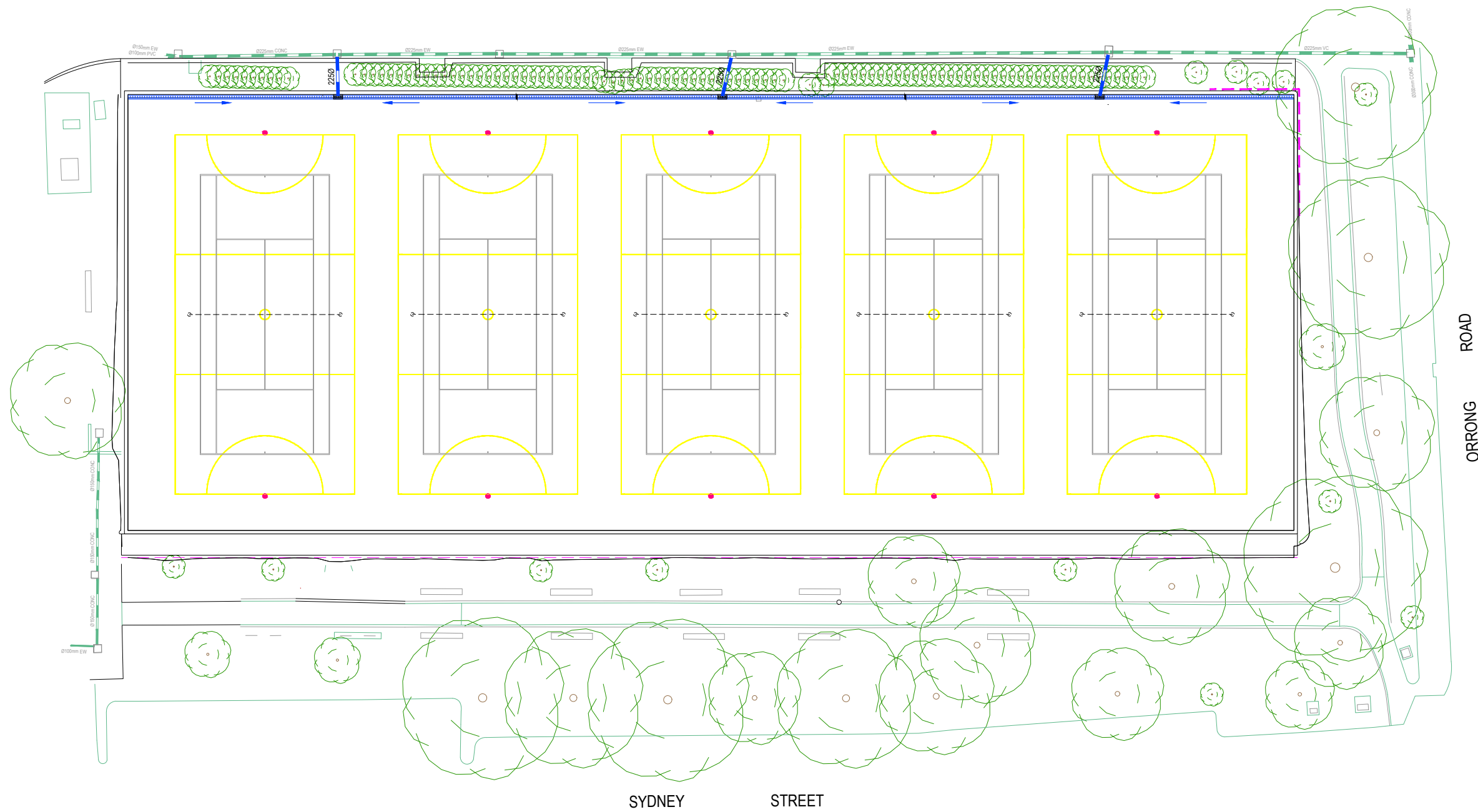

SYDNEY STREET

ORRONG ROAD

REV.	AMENDMENTS	APPD	DATE
T2	NETBALL COURT AMENDMENT	BRG	27.10.2020
T1	ISSUED FOR TENDER	BRG	28.02.2020

© 2015 LD Eng Pty Ltd  
 File: J:\1265\_workspace\1265\123900\_S83PM02\_DESIGN\01\_DESIGN\ACAD\123900SG00.dwg LAYOUT: SG2-04 PLOTTED BY: Nick Keogh PLOT DATE: 27/10/2020 2:31 PM



PM	B. GORDON
DESIGNED	31.10.2019
DESIGNED BY	N.KEOGH
CHECKED	05.11.2019
CHECKED BY	N.MIRATANA
AUTHORISED	05.11.2019
AUTHORISED BY	B.GORDON
MELBWAYS	58 JS
CLIENT REF:	
STATUS:	

**ORRONG PARK TENNIS CENTRE COURT & FLOODLIGHTING UPGRADE**  
 STONNINGTON CITY COUNCIL DRAINAGE PLAN

TENDER 123900SG06 REV. T2

SHEET No. 6 OF 13



LEGEND	
ES	KERB & CHANNEL + TYPE
	3.60m HIGH CHAINLINK FENCE
	CHAINLINK GATE
	EXISTING STRUCTURE
	EXISTING WALL

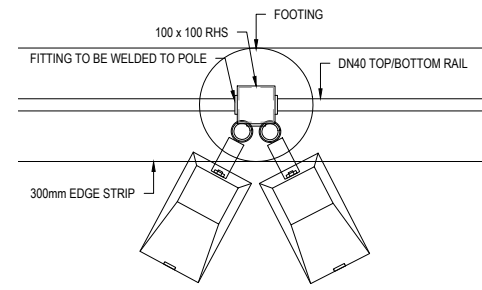

LIGHT POST

DETAIL FP1  
SCALE 1 : 10

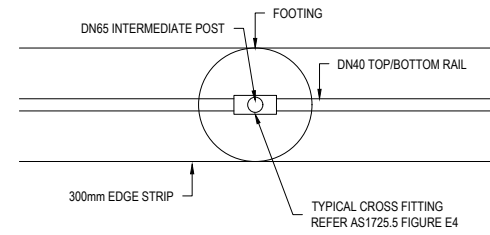

FENCE POST

DETAIL FP2  
SCALE 1 : 10

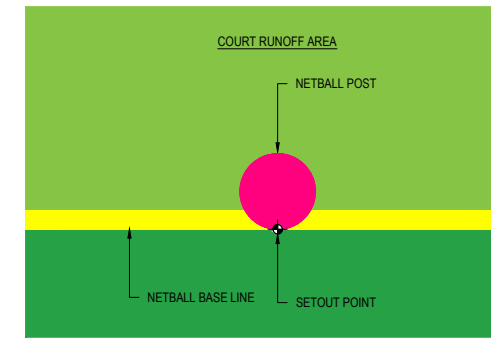

NETBALL POST

DETAIL FP3  
SCALE 1 : 10

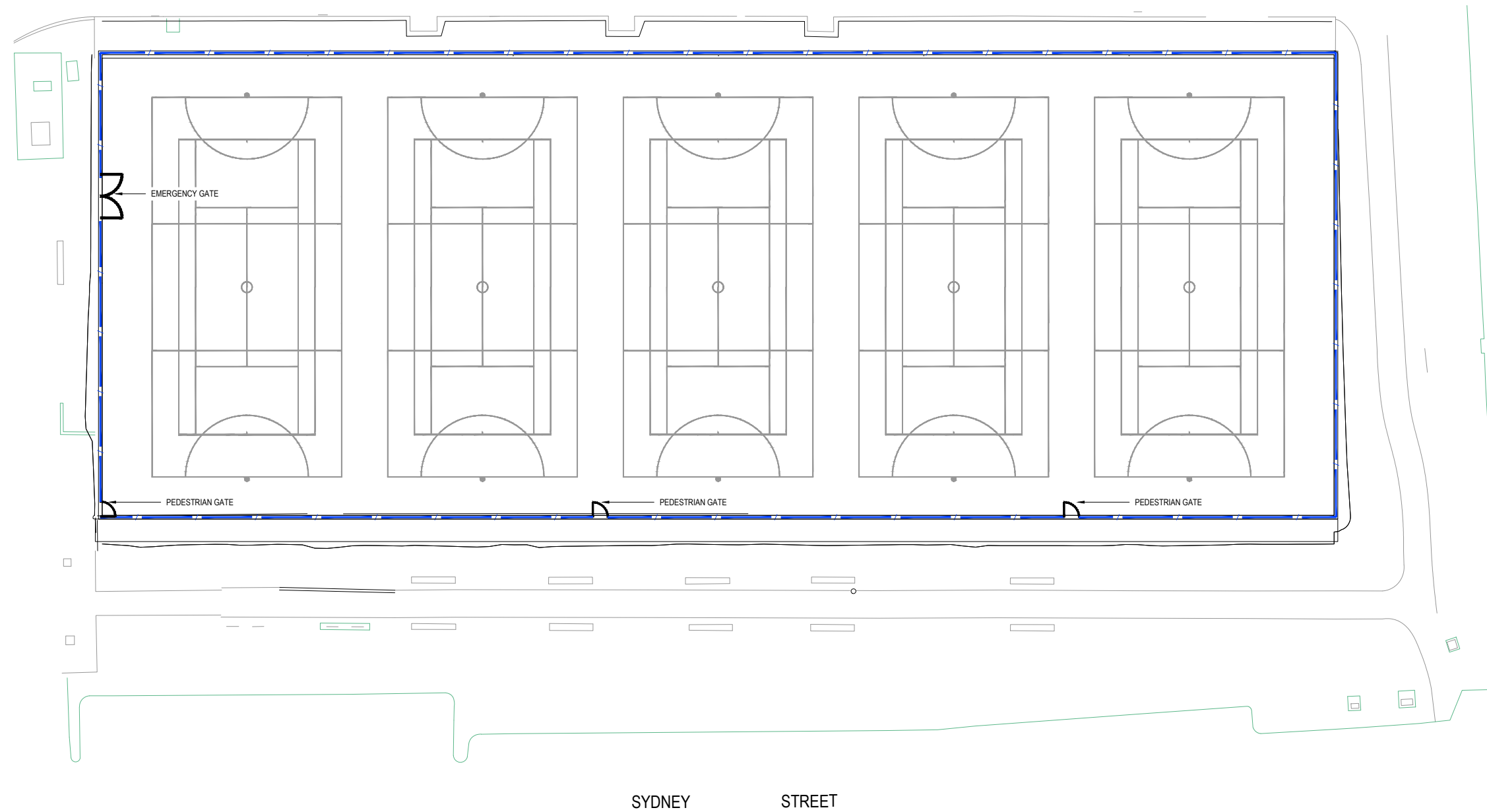

REV.	AMENDMENTS	APPD	DATE
T2	NETBALL COURT AMENDMENT	BRG	27.10.2020
T1	ISSUED FOR TENDER	BRG	28.02.2020

© 2015 LD Eng Pty Ltd  
FILE: J:\1265\_workspace\client\ALMEL\SQL01\123900\_583\PM2 DESIGN\G01 DESIGN\ACAD\123900SG00.dwg LAYOUT: SG2-05 PLOTTED BY: Nick Keogh PLOT DATE: 27/10/2020 2:31 PM



PM	B. GORDON
DESIGNED	31.10.2019
N.KEOGH	
CHECKED	05.11.2019
N.MIRATANA	
AUTHORISED	05.11.2019
B. GORDON	
MELWAYS	58 JS
CLIENT REF:	
STATUS:	

**ORRONG PARK TENNIS CENTRE  
COURT & FLOODLIGHTING UPGRADE**  
STONNINGTON CITY COUNCIL  
FENCE PLAN

TENDER 123900SG07 SHEET No. 7 OF 13 REV. T2



**EARTHWORKS LEGEND**

[Lightest Yellow]	0 TO -0.10 CUT
[Light Orange]	-0.10 TO -0.20 CUT
[Orange]	-0.20 TO -0.30 CUT
[Light Red]	-0.30 TO -0.40 CUT
[Red]	-0.40 TO -0.50 CUT
[Dark Red]	-0.50 TO -0.60 CUT
[Purple]	GREATER THAN -0.60 CUT
[Lightest Green]	0 TO 0.10 FILL
[Light Green]	0.10 TO 0.20 FILL
[Green]	0.20 TO 0.30 FILL
[Dark Green]	0.30 TO 0.40 FILL
[Olive Green]	0.40 TO 0.50 FILL
[Dark Olive Green]	0.50 TO 0.60 FILL
[Darkest Green]	GREATER THAN 0.60 FILL

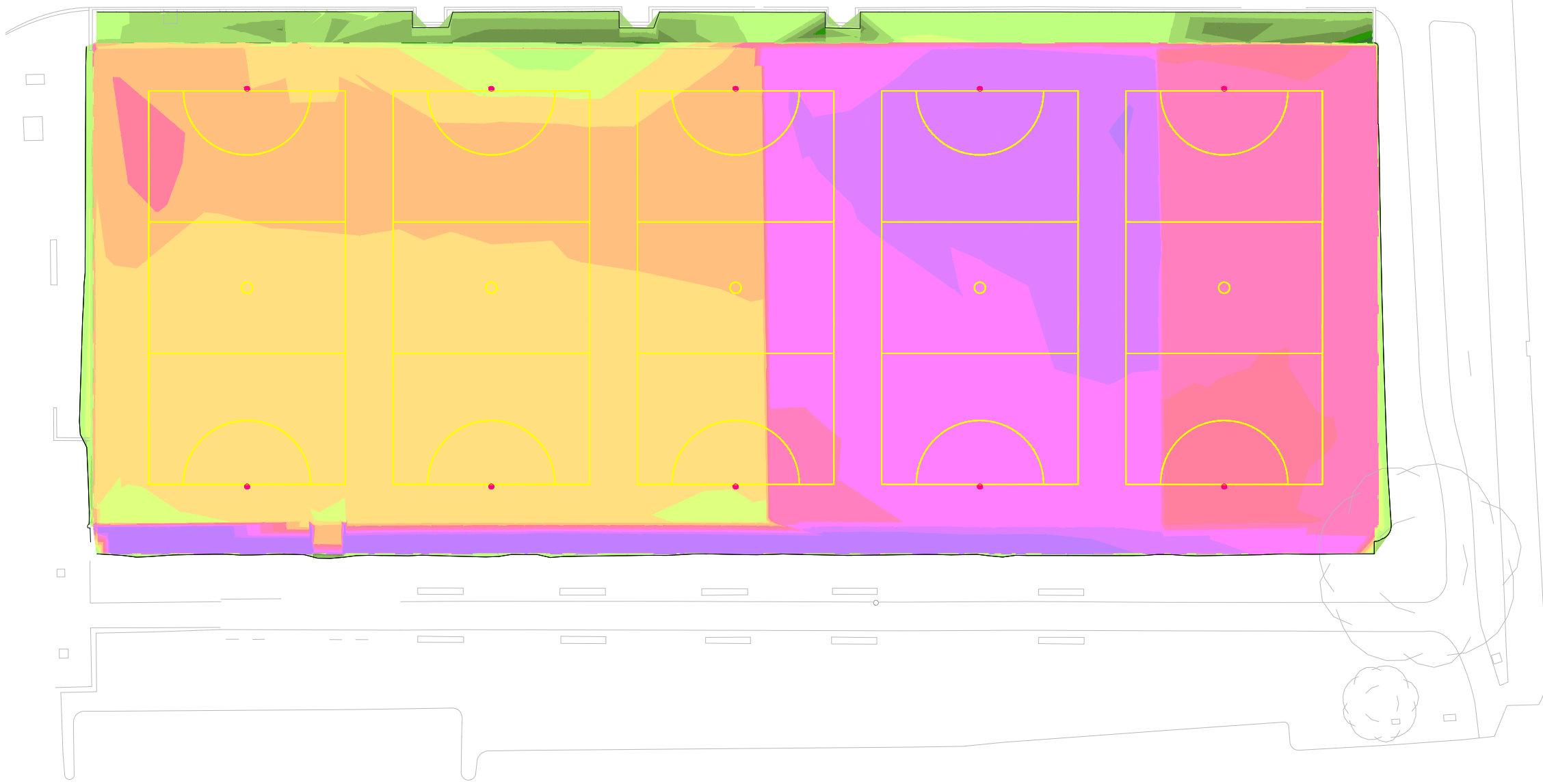

**EARTHWORKS FIELD ONLY**

Total cut	1040
Total fill	70
Total balance	970

**EARTHWORKS NOTES:**

1. VOLUMES ARE CALCULATED AS BEING SOLID
2. SITE STRIPPING REQUIRES 200mm OF MATERIAL TO BE DISPOSED OFF-SITE.
3. EARTHWORKS VOLUMES ARE CALCULATED BETWEEN THE STRIPPING LEVELS AND THE DESIGN SUBGRADE LEVELS OF THE SPECIFIED PAVEMENTS.

SYDNEY STREET

ORRONG ROAD

REV.	AMENDMENTS	APPD	DATE
T2	NETBALL COURT AMENDMENT	BRG	27.10.2020
T1	ISSUED FOR TENDER	BRG	28.02.2020

© 2015 LD Eng Pty Ltd  
 FILE: J:\1205\_workspace\1205\123900\_S83PM02 DESIGN\01 DESIGN\ACAD\123900SG00.dwg LAYOUT: SG2-06 PLOTTED BY: Nick Keogh PLOT DATE: 27/10/2020 2:31 PM



PM	B. GORDON
DESIGNED	31.10.2019
CHECKED	N.KEOGH
AUTHORISED	N.MIRATANA
MELBURNS	B. GORDON
CLIENT REF:	58 JS

**ORRONG PARK TENNIS CENTRE COURT & FLOODLIGHTING UPGRADE**  
 STONNINGTON CITY COUNCIL  
 EARTHWORKS PLAN

TENDER	123900SG08	SHEET No.	8 OF 13
		REV.	T2





LEGEND	
	EXISTING ROCK WALL
	EXISTING TOE OF BATTER
	EXISTING KERB
	EXISTING FOOTPATH
	EXISTING BUILDING
	SECURITY SITE FENCE
	EXISTING TREE TO BE RETAINED (SURVEYED CANOPY)
	EXISTING TREE TO BE REMOVED
	TEMPORARY ACCESS PATH

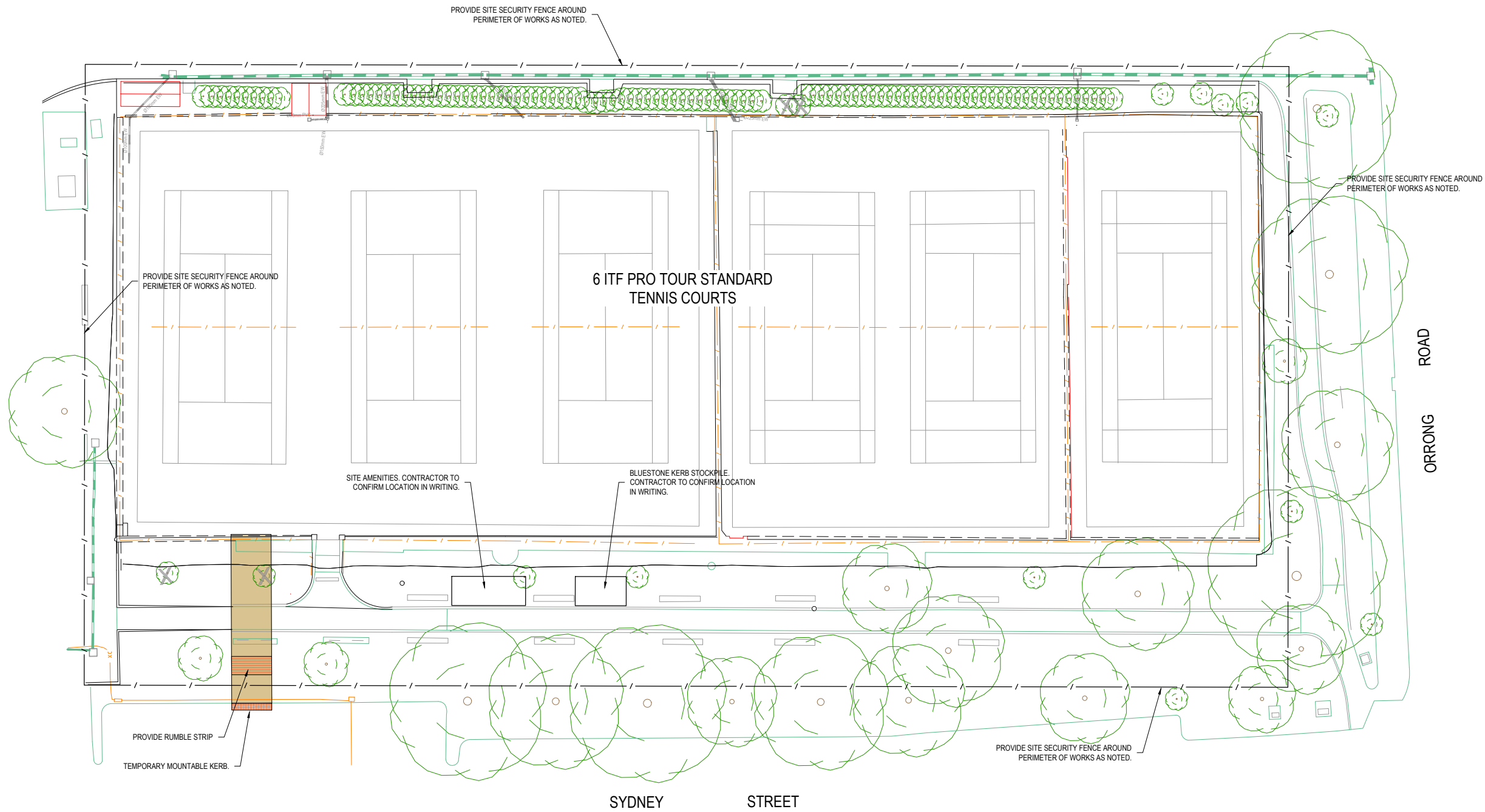

REV.	AMENDMENTS	APPD	DATE
T2	NETBALL COURT AMENDMENT	BRG	27.10.2020
T1	ISSUED FOR TENDER	BRG	28.02.2020

© 2015 LD Eng Pty Ltd  
 FILE: J:\12305\_workspace\12305\1230500\_583PM02 DESIGN\01 DESIGN\ACAD\12305000.dwg LAYOUT: S02-07 PLOTTED BY: Nick Keogh PLOT DATE: 27/10/2020 2:31 PM



PM	B. GORDON
DESIGNED	31.10.2019
CHECKED	05.11.2019
AUTHORISED	05.11.2019
MELBURN	B. GORDON
CLIENT REF:	58 JB

**ORRONG PARK TENNIS CENTRE COURT & FLOODLIGHTING UPGRADE**  
 STONNINGTON CITY COUNCIL  
 SITE ACCESS & TEMPORARY WORKS PLAN

TENDER	123900SG09	REV.	T2
--------	------------	------	----

SHEET No. 9 OF 13

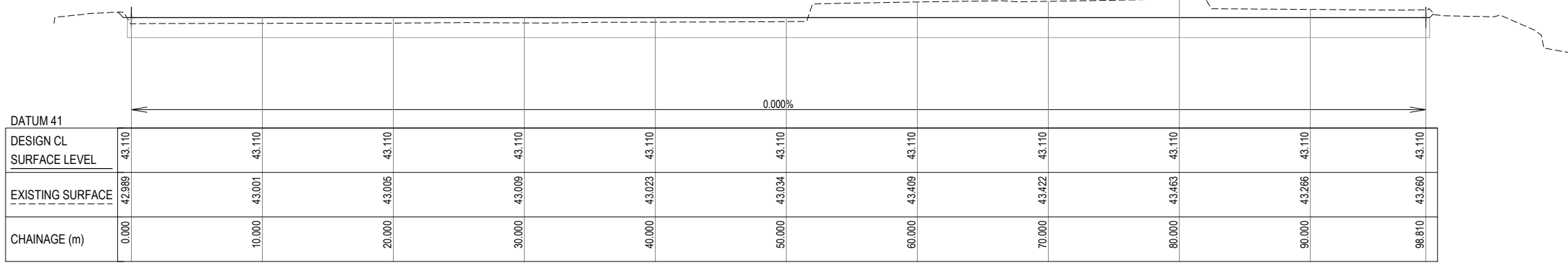

COURTS - LONGITUDINAL SECTION

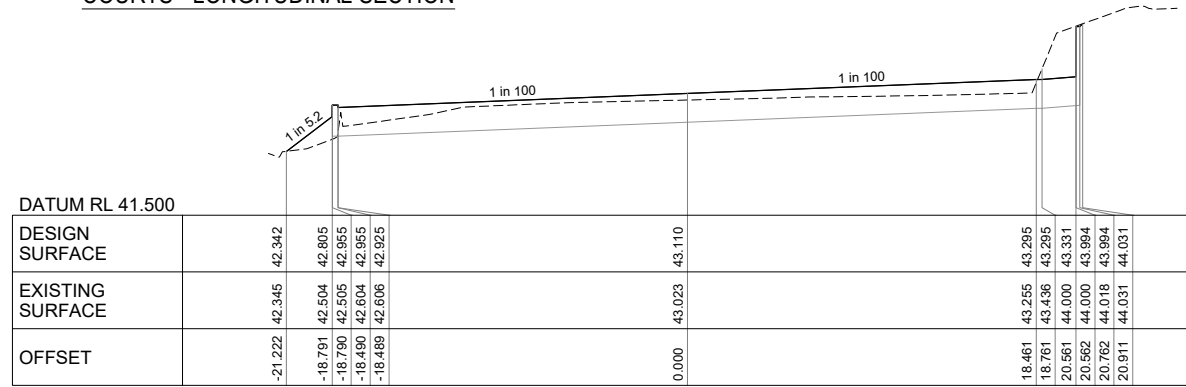

CH. 40.000

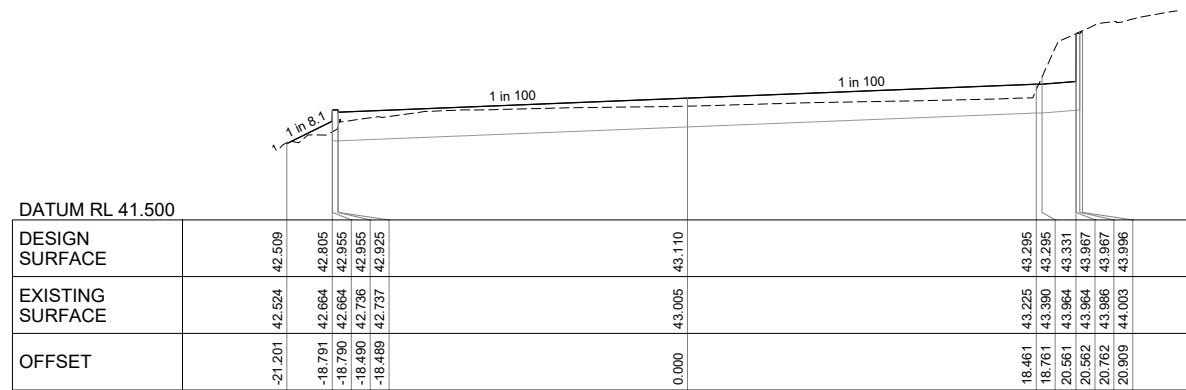

CH. 20.000

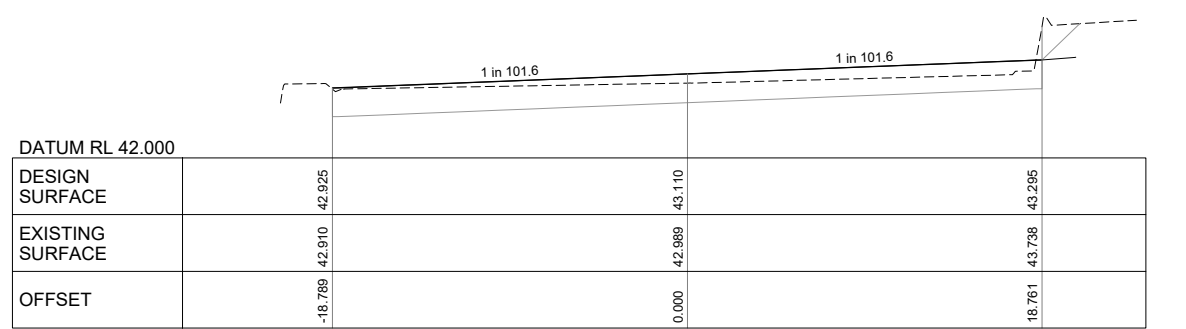

CH. 0.000

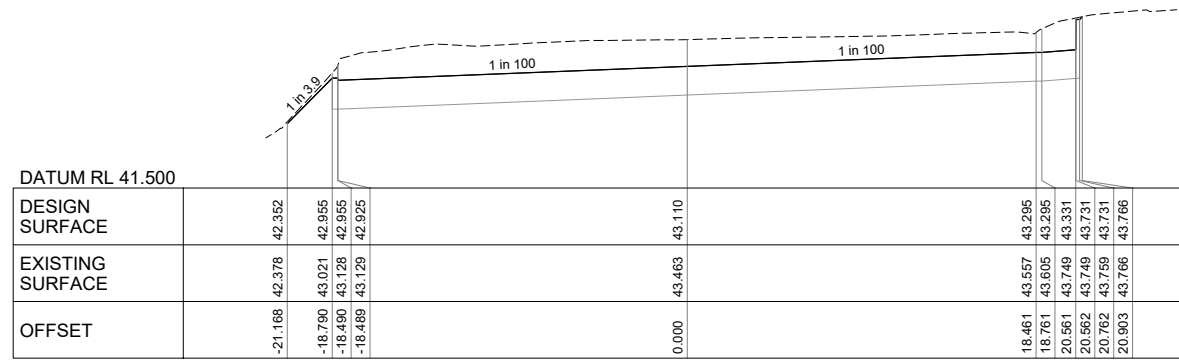

CH. 80.000

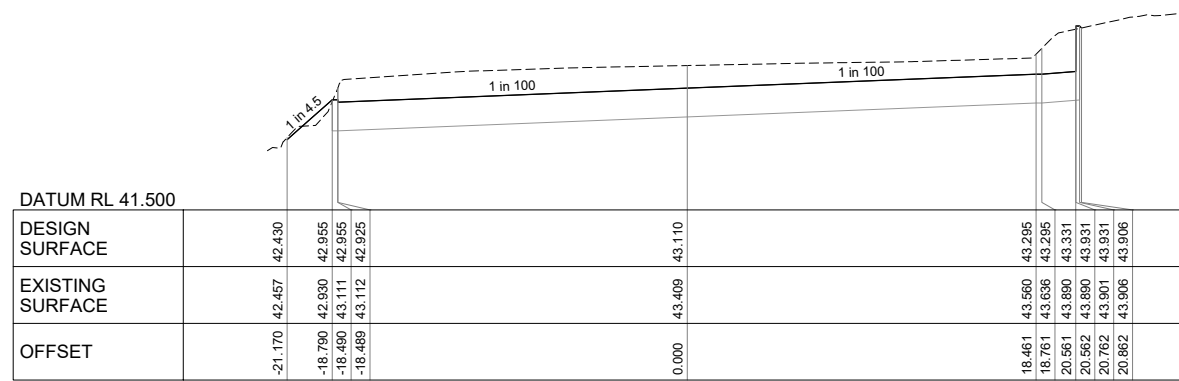

CH. 60.000

FIELD 1 - CROSS SECTIONS

REV.	AMENDMENTS	APPD	DATE
T2	NETBALL COURT AMENDMENT	BRG	27.10.2020
T1	ISSUED FOR TENDER	BRG	28.02.2020

© 2015 LD Eng Pty Ltd  
FILE: 123900SG10 LAYOUT: 123900SG10\_PLOT DATE: 28.02.2020



PM	B. GORDON
DESIGNED	31.10.2019
CHECKED	N.KEOGH
AUTHORISED	N.MIRATANA
MELBURN	05.11.2019
CLIENT REF:	B. GORDON
STATUS:	58 JS

**ORRONG PARK TENNIS CENTRE COURT & FLOODLIGHTING UPGRADE**  
STONNINGTON CITY COUNCIL COURT SECTIONS



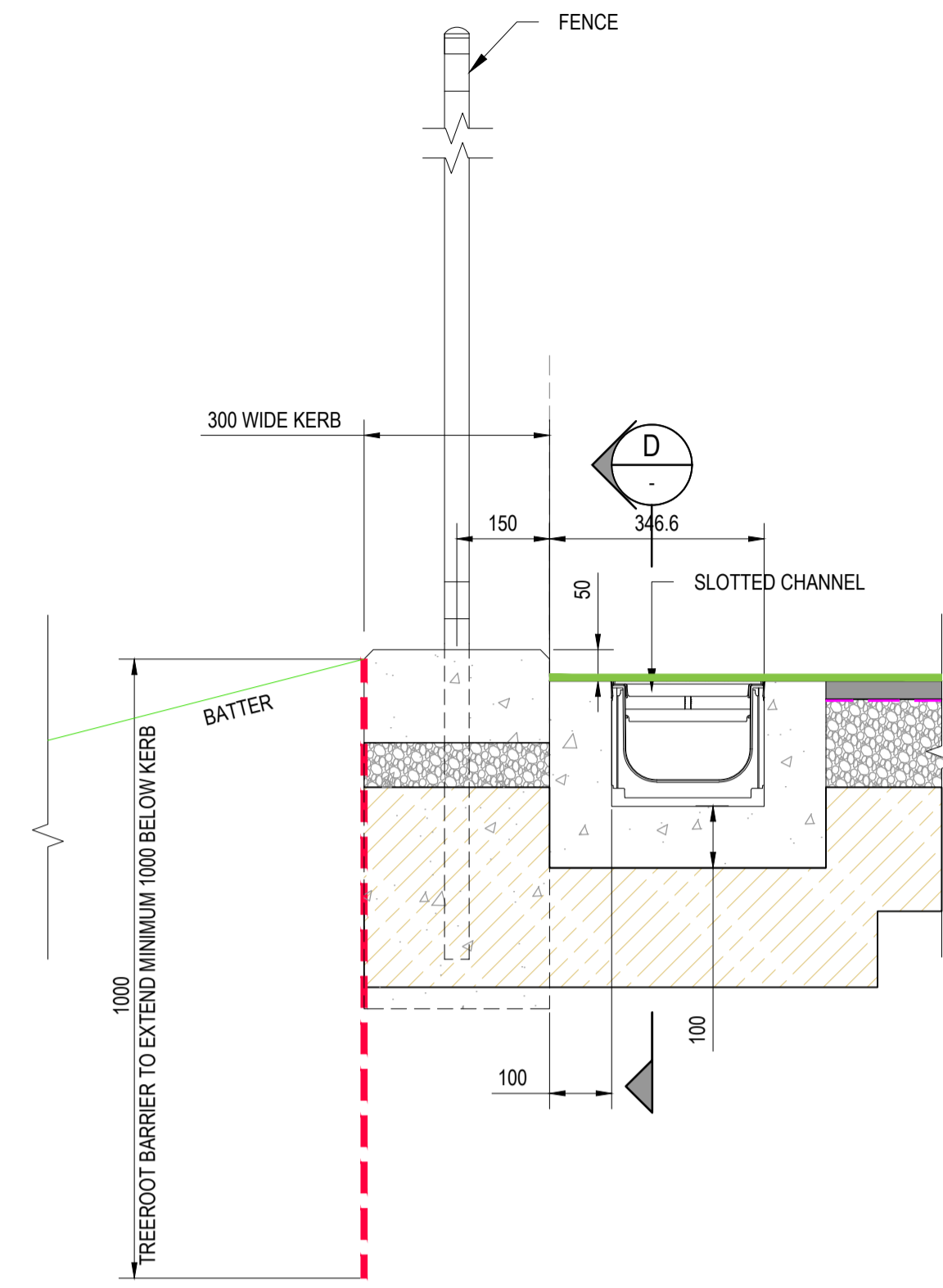

TYPICAL LOW-EDGE INTERFACE

SECTION A  
SCALE 1 : 10  
SG05

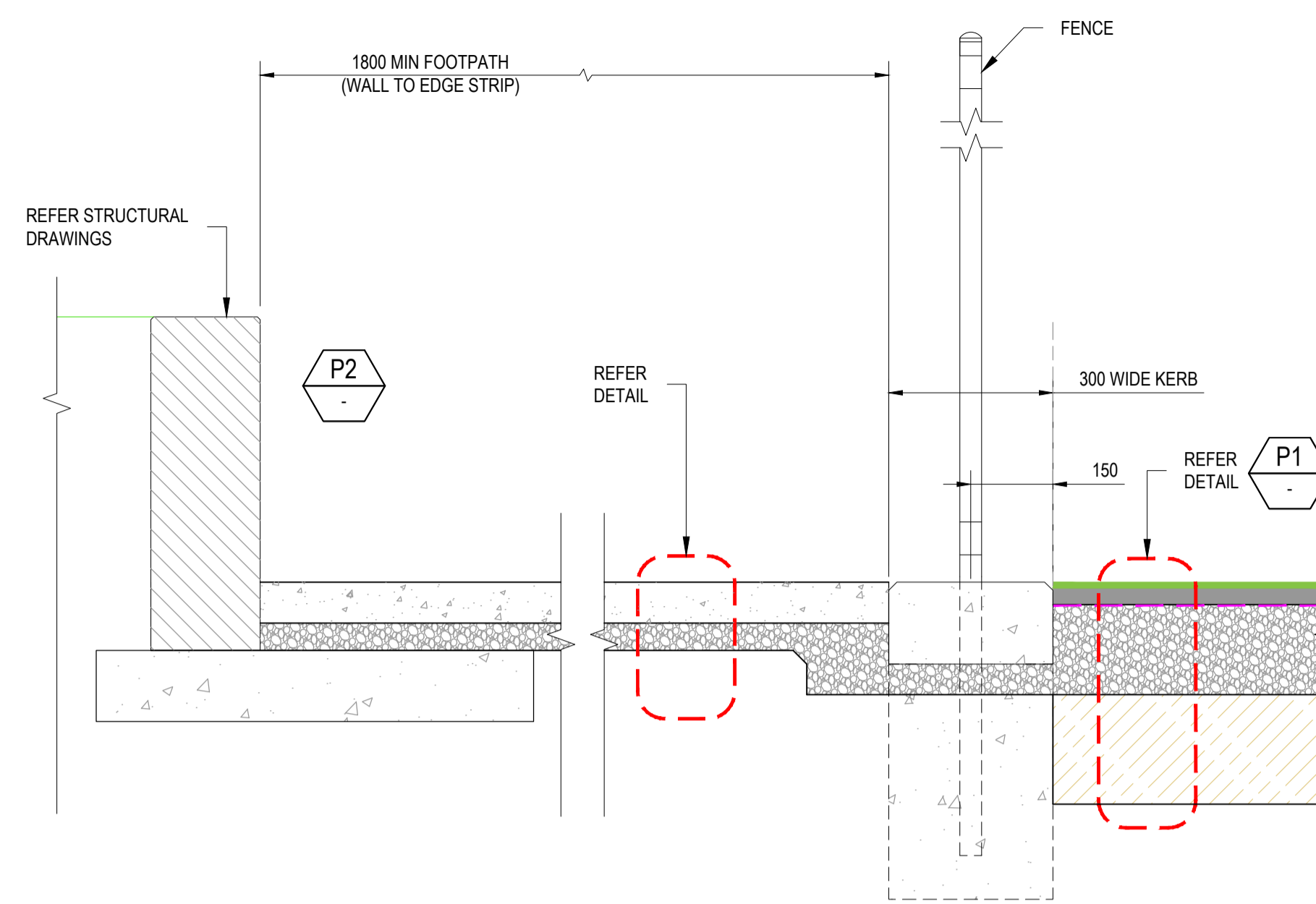

TYPICAL HIGH-EDGE INTERFACE

SECTION B  
SCALE 1 : 10  
SG05

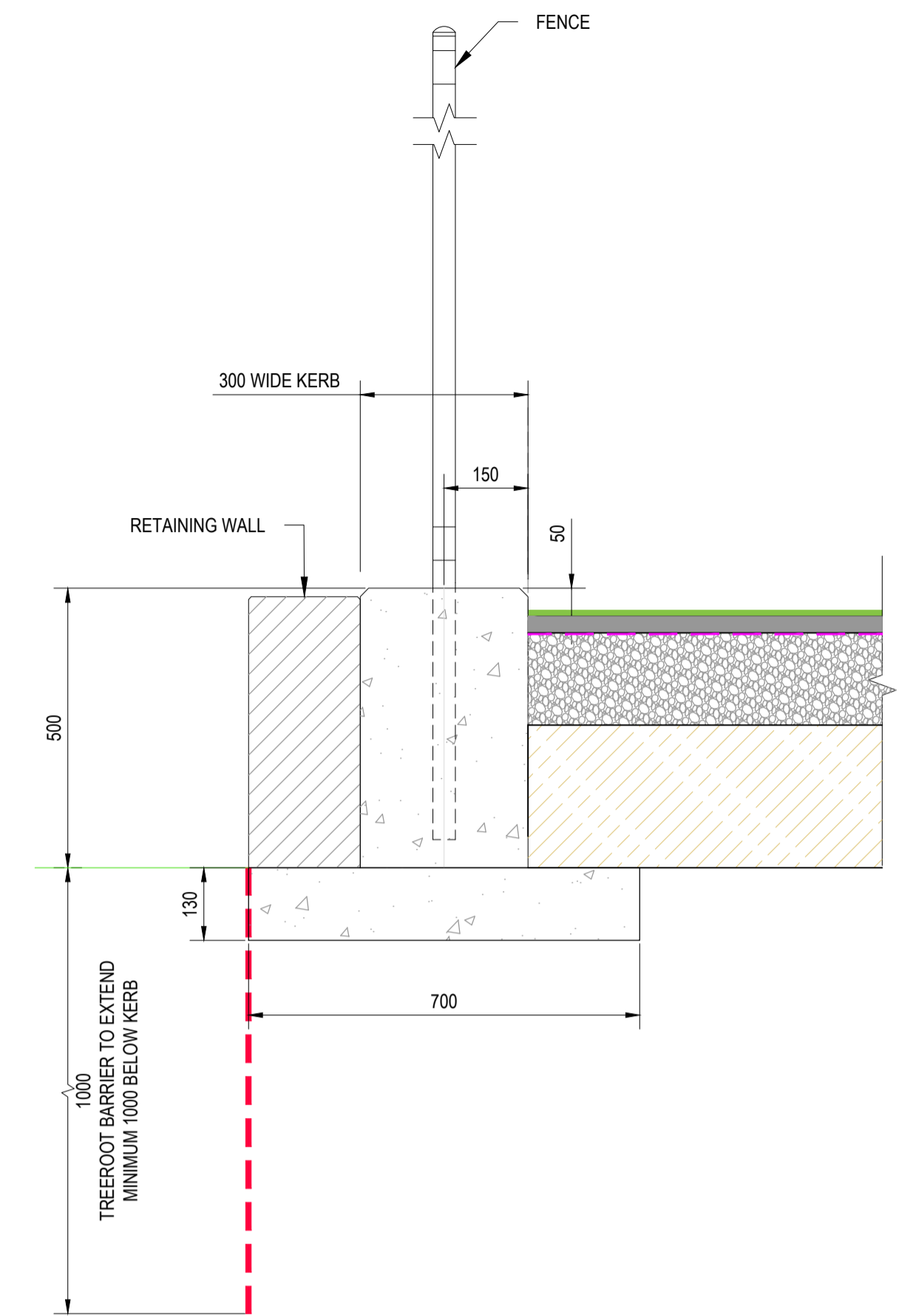

TYPICAL LOW-EDGE INTERFACE

SECTION C  
SCALE 1 : 10  
SG05

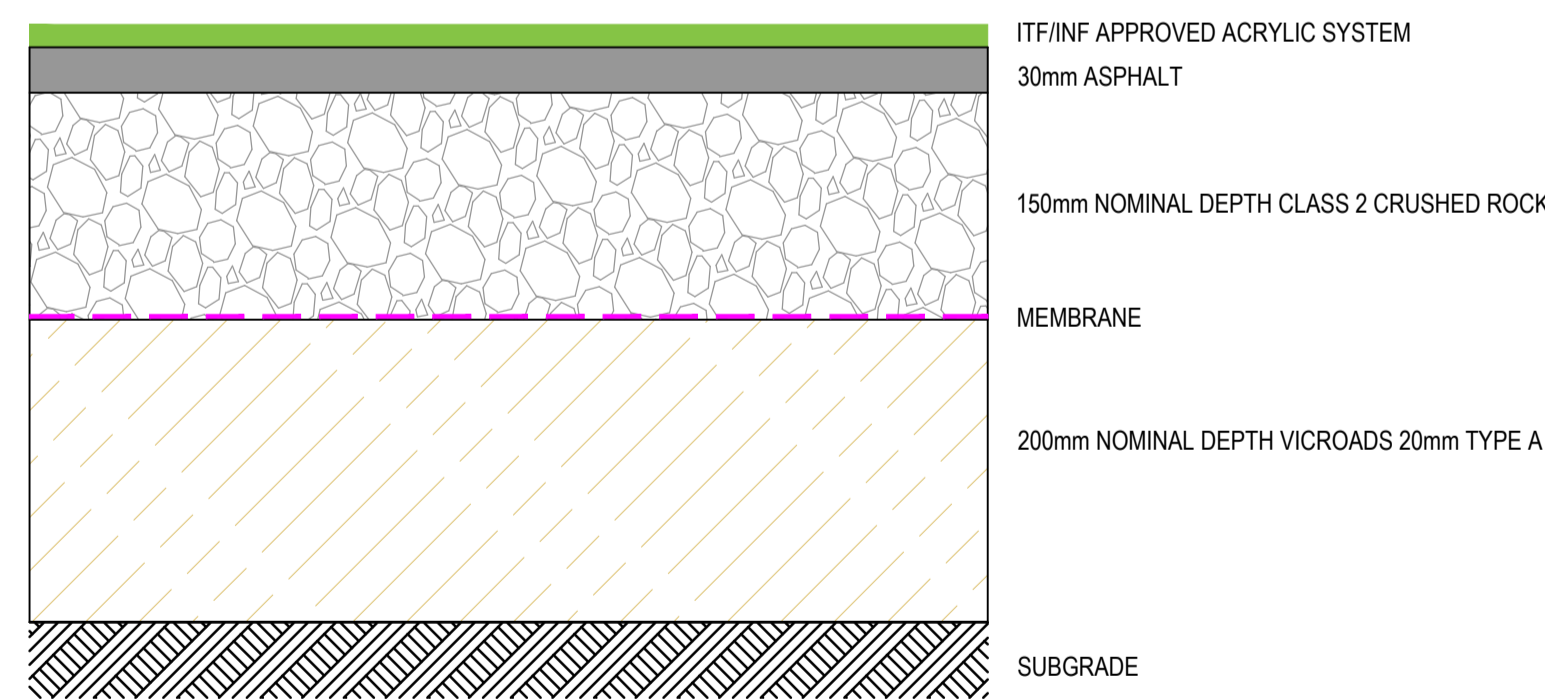

PROFILE

DETAIL P1  
SCALE 1 : 5

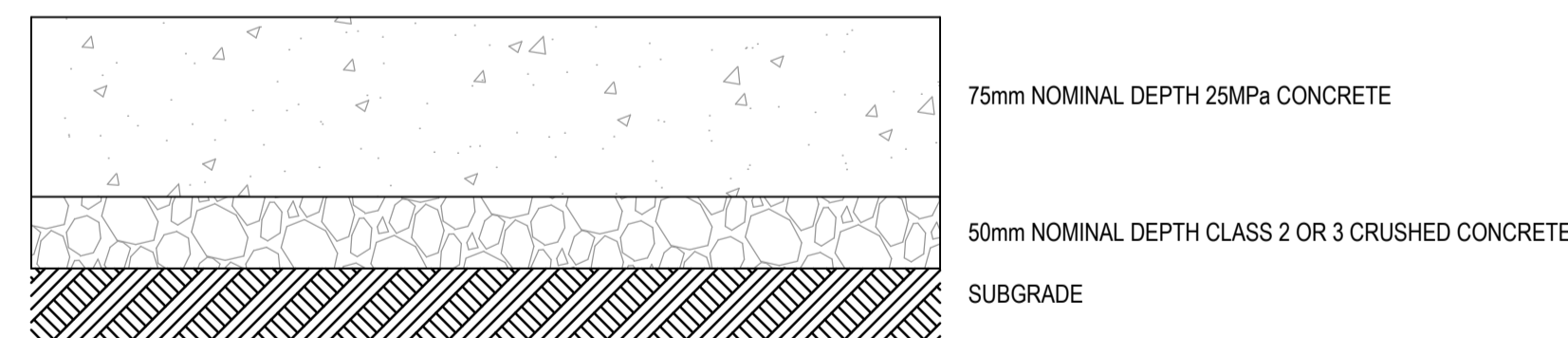

FOOTPATH

DETAIL P2  
SCALE 1 : 5

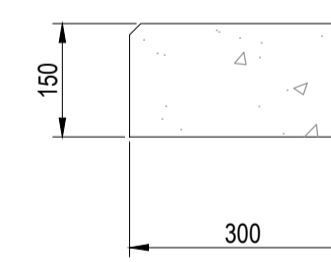

300 ES KERB

DETAIL K1  
SCALE 1:20

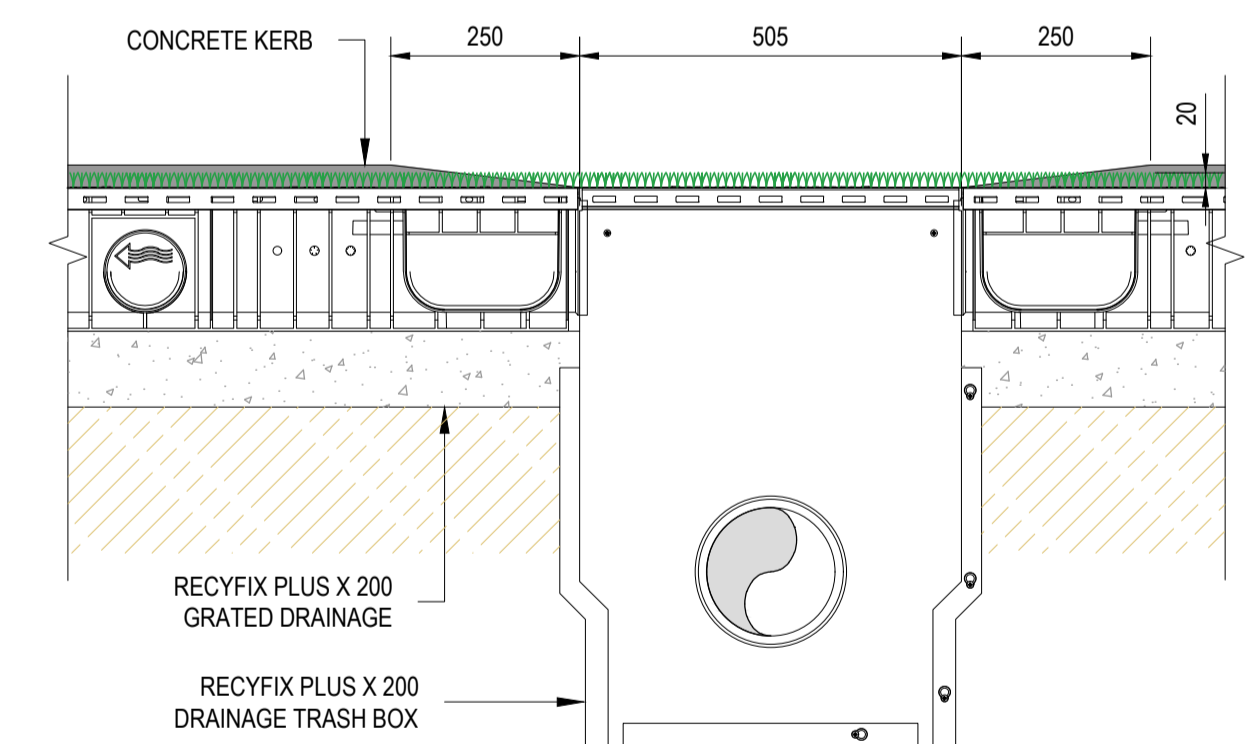

TYPICAL TRASH BOX CONNECTION

SECTION D  
SCALE 1 : 10

PAVEMENT PROFILES

REV.	AMENDMENTS	APP'D	DATE
T3	PAVEMENT PROFILE AMENDED	BRG	03.05.2021
T2	NETBALL COURT AMENDMENT	BRG	27.10.2020
T1	ISSUED FOR TENDER	BRG	28.02.2020

© 2015 LD Eng Pty Ltd  
FILE: J11245 - Works\special\del\AJM\ELSC\01123900\_583PM02 DESIGN\01 DESIGN\ACAD\123900-SG6-SD.dwg LAYOUT: SG6-01 PLOTTED BY: Brent Gordon PLOT DATE: 3/5/2021 9:36 AM



Level 1, 1-5 Northite Road  
Notting Hill, Vic 3168  
Ph: 03 9562 7424  
ldeng.com.au

PM	B. GORDON
DESIGNED	31.10.2019
CHECKED	05.11.2019
AUTHORISED	05.11.2019
MELBURNS	58 J6
CLIENT REF:	
STATUS:	

ORRONG PARK TENNIS CENTRE  
COURT & FLOODLIGHTING UPGRADE  
STONNINGTON CITY COUNCIL  
STANDARD DETAILS - 1

TENDER 123900SG11  
SHEET No. 11 OF 13  
REV. T3

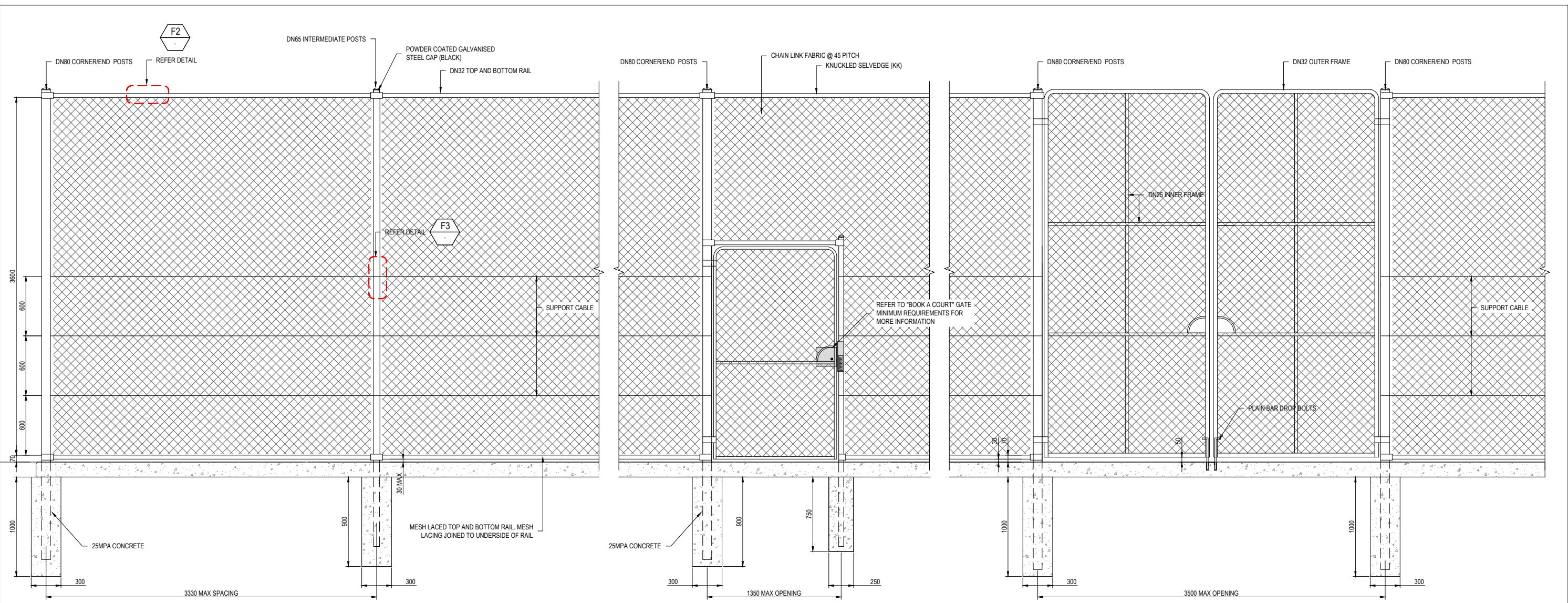

TYPICAL FENCE

TYPICAL SPECTATOR GATE

TYPICAL ACCESS GATE

DETAIL F1  
SCALE 1:20

**TABLE B3  
FENCE MEMBER DETAILS AND CONCRETE FOOTINGS (BASEPLATES)—CLASS 1 (MEDIUM QUALITY)**

Nominal height of chain link fabric mm	Type of post/rail stay	Nominal size (DN) mm	Quality	Outside diameter (OD)	Minimum wall thickness (t)	Minimum size of concrete footings (where possible)		Baseplate option for bolting posts to concrete pavement. (If required by client, refer to AS1725.1-2010 Appendix F) mm	Minimum size masonry anchors
						Diameter mm	Depth mm		
3000 or 3600	T-Junction and Corner Posts	DN65	Medium	88.9	4.0	300	*900		
	End posts	DN80	Medium	88.9	4.0	300	*1000		
	Intermediate posts	d65	Medium	76.1	4.5	300	*900		

**USE CAST IN POSTS FOR THESE FOOTINGS**

\*PRELIMINARY SIZING FOR HARD CLAY (UNDISTURBED NATURAL). CONTRACTOR TO CHACK SOILS ON SITE AND CERTIFY DEPTH DESIGN OF FOOTINGS.

**NOTE:**  
1. ALL DETAILS TO BE IN ACCORDANCE WITH AS1725.5 UNLESS SHOWN OTHERWISE ON THESE DRAWINGS.

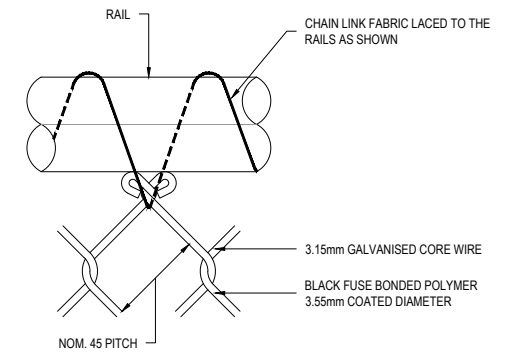

TYPICAL MESH LACING

DETAIL F2  
NOT TO SCALE

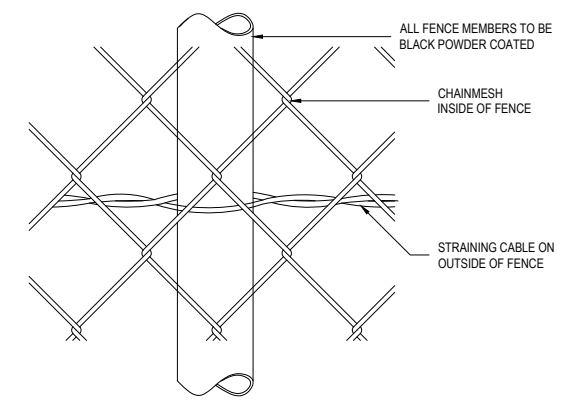

TYPICAL STRAINING CABLE POST CONNECTION

DETAIL F3  
NOT TO SCALE

REV.	AMENDMENTS	APPD	DATE
T2	NETBALL COURT AMENDMENT	BRG	27.10.2020
T1	ISSUED FOR TENDER	BRG	28.02.2020

© 2015 LD Eng Pty Ltd  
FILE: J:\12345 - Workspaces\ldem\AJMEL\SC1\01123900\_883\PM02 DESIGN\G1 DESIGN\CAD\123900-856-SD.dwg LAYOUT: 856-02 PLOTTED BY: Nick Keogh PLOT DATE: 27/10/2020 2:32 PM



Scale 1:1000, A1  
Horizontal 0 10 20 30 40 50  
Vertical 0 10 20 30 40 50

PM	B. GORDON
DESIGNED	31.10.2019
CHECKED	05.11.2019
AUTHORISED	05.11.2019
MELBURN	58 JS
STATUS	

**ORRONG PARK TENNIS CENTRE COURT & FLOODLIGHTING UPGRADE**  
STONNINGTON CITY COUNCIL  
STANDARD DETAILS - 2

TENDER 123900SG12  
REV. T2