

MOUNT STREET PRECINCT POCKET PARKS & SHARED ZONES

COMMUNITY UPDATE PACKAGE
November 2021





Contents

Project Overview and Timeline	1
Shared Zone and Pocket Park Perspectives	2
Community Consultation Round 3 Summary	3
Community Consultation Round 3 Comments	4
Community Consultation Round 3 Comments	5
Shared Zones	6
Pocket Parks	7
Pocket Parks	8
Materials	9
Furniture	10
Planting	11
Lighting	12
Street Art	13
Next Steps	14

Project Overview and Timeline

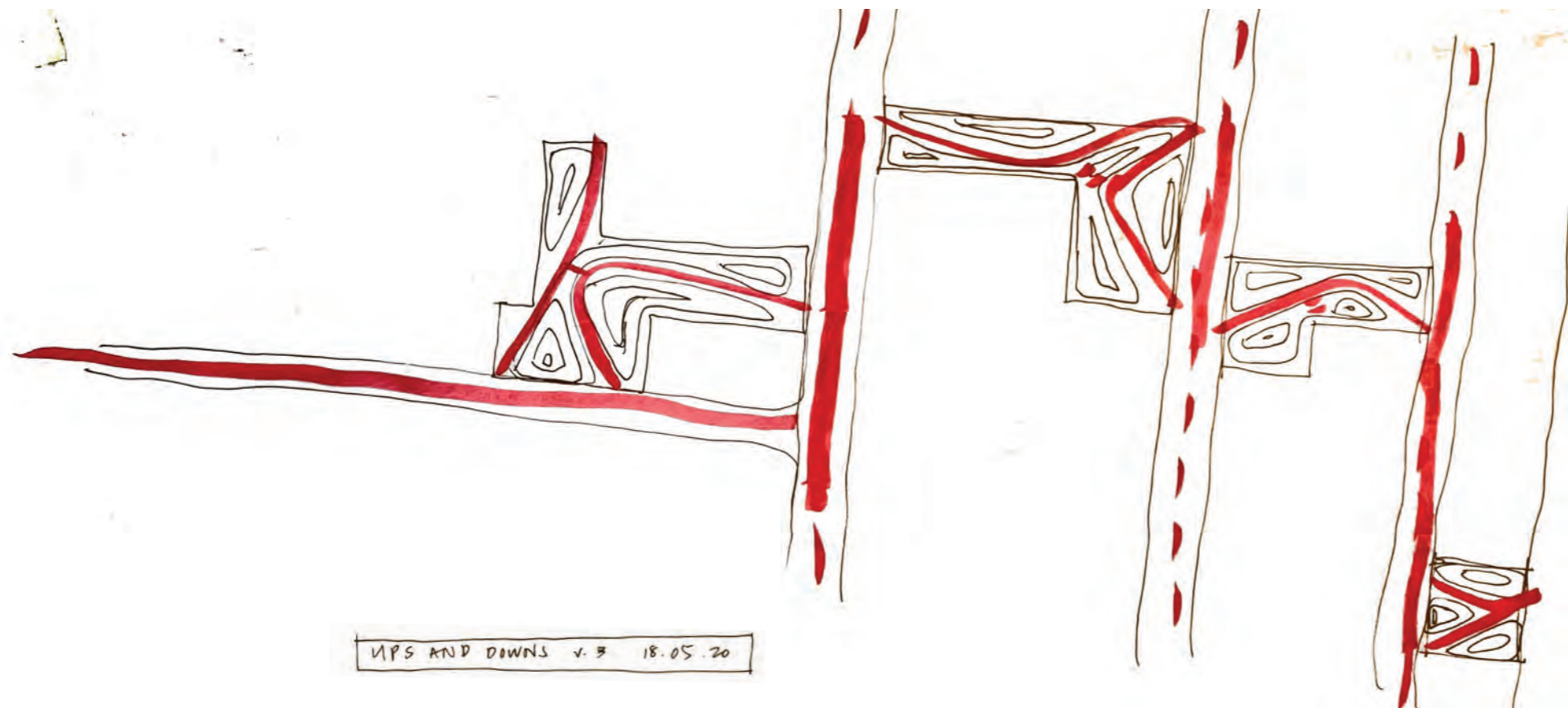

Location

The Mount Street Area is located to the east of Chapel street and includes Anchor Place, Cecil Place, Clifton Street, Mount Street, Regent Street, Bangs Street and King Street. In November 2019, the Mount Street Area Masterplan was endorsed by Council for implementation.

Masterplan Development

In 2018/19 a masterplan was produced for the Mount St Precinct that formed a framework for future upgrades to the area. Two rounds of community consultation occurred during this process to form the final Masterplan endorsed by Council in October 2019.

Design Development

The design development report further resolved the ideas and feedback from the masterplan development phase of the project. This report zoomed in on details for each of the pocket parks and shared zones in the Precinct. Material palettes, furniture and planting were all developed for the third round of community consultation prior to moving into the next phase of the project.

Documentation: Prepare Construction Drawings

In 2021, Stage 1 of the project is been documented to prepare drawings for construction. Stage 1 includes the East portion of Mouclif Park, Regent Street shared zone and Bangs Park. Constructions works are programmed to start mid 2022

The 'Ups and Downs' concept re-imagines what the original landscape of Prahran might have been like. Inspired by remnant natural sites such as the Tootagaoorak swamp in Mornington, the design for the network of open spaces will use small topographical interventions to create a variety of social spaces.

Shared Zone and Pocket Park Perspectives



Anchor Place, looking East



Anchor Park



Anchor Park



Clifton Street, looking North



Mouclif Park



Mouclif Park



Remo Park



Regent Street, looking South



Bangs Park

Community Consultation Round 3 Summary

In 2020 an online survey to capture community feedback was live from 24 August to 21 September. At the close of the survey, 53 responses were received **with 71% of respondents supporting the overall concept design.**

An online information session, hosted by the design team on Tuesday 8 September, was well received with 20 community members in attendance. The live discussion with designer and Council officers attracted 35 questions from participants, posted live during the session. After the information session, email responses to all questions were sent to all participants.

The following three pages are the questions and responses from the round 3 Community Consultation session. Dashed pink lines around these questions direct you to the relevant pages in this report to show how these items have progressed during the preparation of construction drawings phase of the project.

LOVE IT
DISLIKE
NEUTRAL

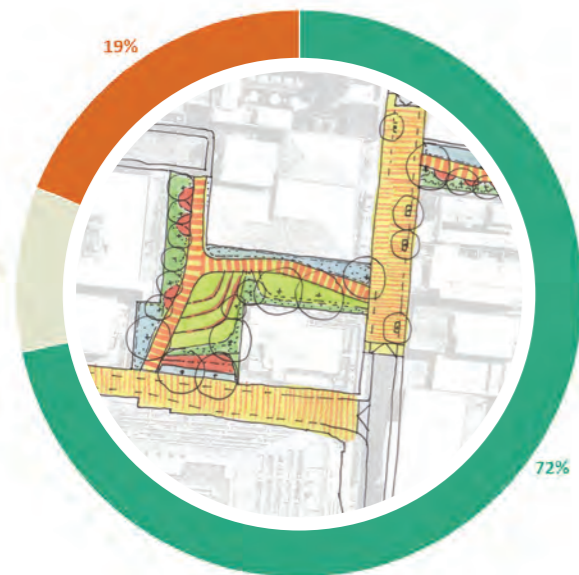

Overall Masterplan

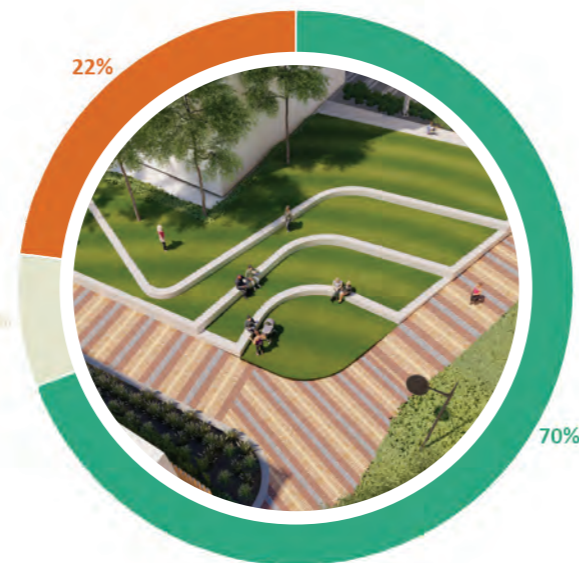

Anchor Park

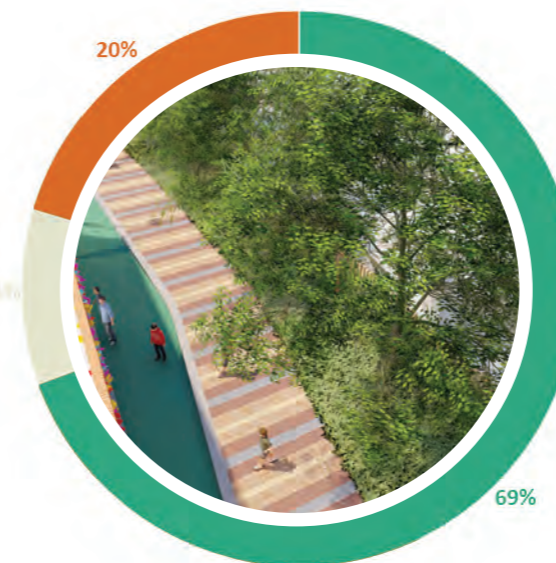

Mouclif Park

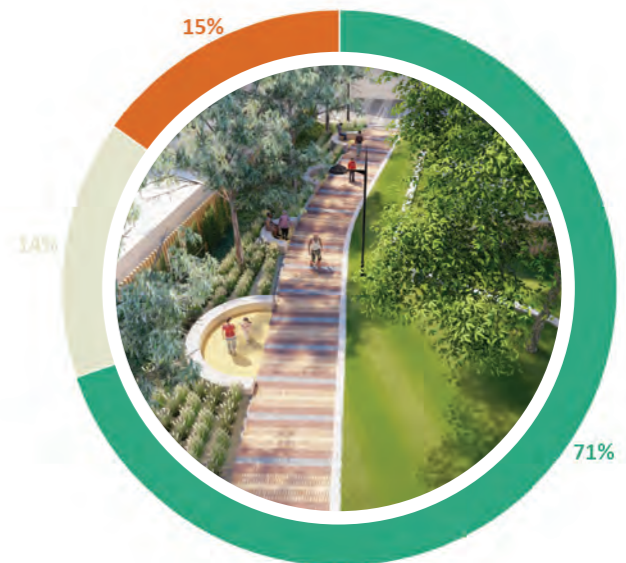

Remo Park

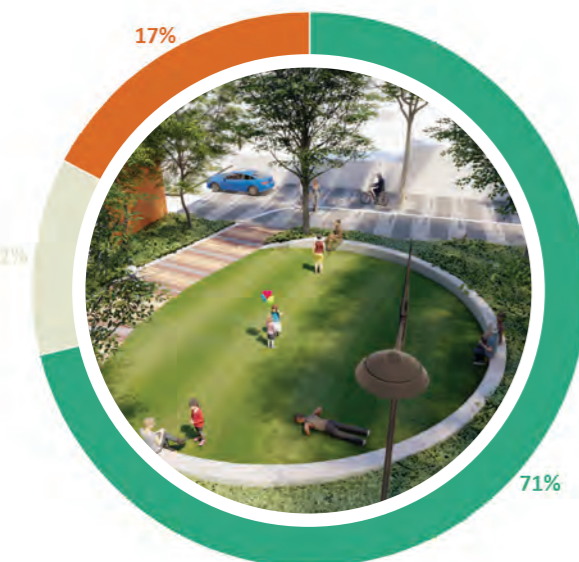

Bangs Street Park

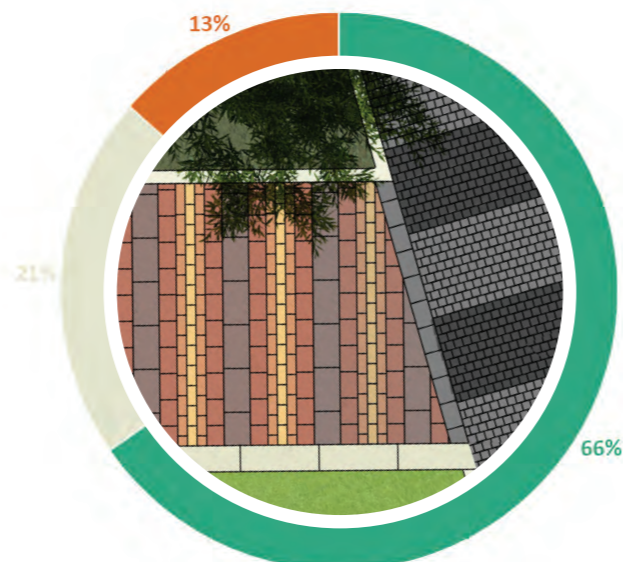

Materials

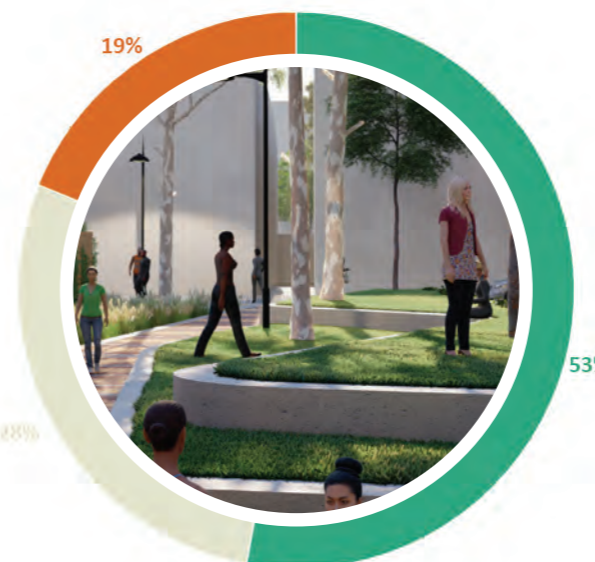

Furniture

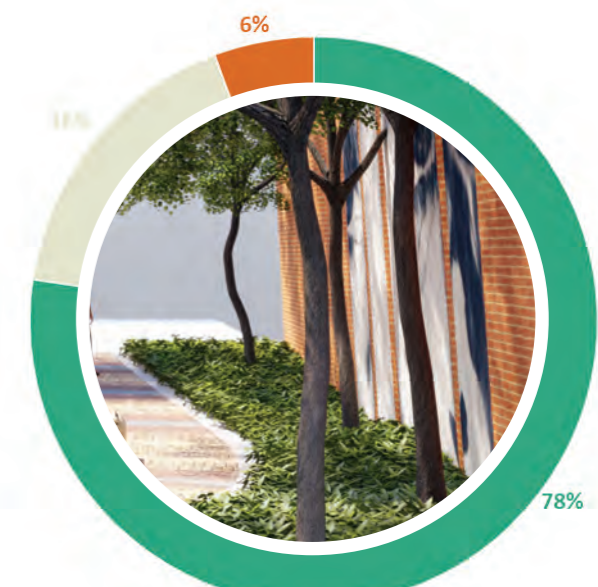

Planting

Community Consultation Round 3 Comments

ITEM	QUESTIONS FROM PREVIOUS COMMUNITY CONSULTATION IN NOVEMBER 2020	COUNCIL COMMENTS - NOVEMBER 2020	RESPONSE IN THIS PACKAGE - NOVEMBER 2021
PLANTING	<p>Will the swamp gardens have indigenous plantings?</p> <p>I am desperate for natural spaces and biodiversity. I don't think we need another amphitheatre as there's one in the square. we need habitat restoration</p> <p>Can the plan accommodate meadows of local indigenous flowers and grasses, minimising lawn hopefully minimises noise from mowers?</p>	<p>The pocket parks need to provide a balance of planting and open grass areas. A diverse planting palette, which will include vegetation that is indigenous to the local area will be used to encourage native fauna to the site and open grassed areas will provide a number of opportunities for local residents to use the site including, picnics, exercise, games, events and a place to play for kids.</p>	<p>The planting palette has been updated, refer page 11. All of the shrub and groundcover planting are natives. The trees are a mix of native species and some exotic deciduous trees to allow the Winter light through to the parks</p>
LIGHTING	<p>The lighting in the renders looks sparse - has there been a review of lighting to ensure safety at night?</p> <p>Can solar be considered for any lighting associated with the parks?</p> <p>I am also concerned that the light colour of the stone for the shared paths will be glary (similar time cato st where even on a gloomy day I can hardly see a thing)</p> <p>Has consideration been given to light pollution? or is the lighting connected to sensors?</p>	<p>The renders shown within the concept designs are indicative only to represent a general 'feel' for the spaces. The next stage of the design process will include engaging a lighting consultant to recommend appropriate light spacing based on relevant Australian standards. This process will also include investigating opportunities for solar lighting, sensors to manage light spill through the night and provision of low energy use bulbs such as LEDs.</p>	<p>A lighting specialist has calculated the appropriate number of lights for the shared zones and parks. Solar lights are utilised within the park spaces that have the ability to function autonomously for 10 days without sunlight. Refer page 12 for details on lighting.</p>
VEGGIE GARDENS	<p>Were community vegetable gardens considered for any of the parks?</p> <p>Would love vegetable garden! great idea</p> <p>Would LOVE veg garden!</p>	<p>At this stage, no community gardens are proposed within these designs. However, there may be an opportunity to trial some veggie gardens in the existing pocket parks to see how the community respond.</p>	<p>Community veggie gardens were considered for the project but not adopted, refer page 7. A Community Garden report will be considered at an upcoming Council meeting</p>
CARS, PEDESTRIAN SAFETY & PARKING	<p>Cars currently speed down bangs St. opening up regent, mount and Clifton might encourage the same. Are you considering speed humps to protect pedestrians?</p>	<p>There are shared zones proposed along regent, Mount and Clifton Streets. Surface material, design, lighting and signage of the shared zones will give priority to pedestrians to improve safety. The shared zones all begin and end with a level change that will be similar to a speed bump. This is indicatively shown on the plans with a rectangle and arrow at each shared zone. Where possible, trees have also been included to further slow cars. As the designs progress through the next level of detail. A range of safety measures designed to slow traffic and identify the space as a shared zone will be incorporated in to each space.</p>	<p>Signage will be included at either end of the shared zones, indicating that different rules apply within these zones. The speed limit will be reduced and there will be bollards, planters and seating to create barriers. Refer page 6 for details</p>
	<p>The plans look great, but parking is a major issue.</p> <p>I also have considerable concerns over parking in general, it already makes the area not overly liveable to receive visitors or contractors.</p> <p>How will you maintain existing parking bays, introduce bike lanes, build wider footpaths and plant more trees all in the same amount of space?</p>	<p>The concept of shared zones is to create a pedestrian friendly space; it will combine and simplify the elements of a typical street. Bike lanes, footpaths and roads are less divided in a shared zone, which creates more space for all users. The proposed shared zones within the Mount Street masterplan redistribute this space, so it is equitable and safe for all users. Some car parks may be lost, however the community will gain a series of well-connected parks and open spaces that will allow for local events, exercise, recreation, more cafe and dining opportunities and generally improve the health and wellbeing of the local community. These benefits have been well supported through the community consultation process on this project to date.</p>	<p>As communicated in the Masterplan stage and earlier community consultation sessions, car parking will be removed within the shared zones. In order to achieve an improved community space, a balance between vehicles and other modes of transport needs to be achieved. Car parking either side of the shared zones will be retained with new signage installed to make parking locations clear.</p>

Community Consultation Round 3 Comments

FURNITURE	<p>Has any seating with back support been considered? concrete benches might be practical but not comfortable for sitting for more than a short period.</p> <p>Would love to see some consideration of tables, too, not just seating.</p>	<p>Different types of furniture for different needs will be considered and detailed in the next phase of the project. The masterplan identifies where the most suitable locations for seating, and proposes various styles. The detail of these styles will be developed in the next phase design and we will include seats with backrests as well as tables.</p>	<p>A variety of furniture types have been developed, refer page 10.</p>
SUSTAINABILITY	<p>Can reclaimed or recycled (recycle) material be used for furniture.</p>	<p>Yes, we will investigate this further in the next phase of design.</p>	<p>Recycled bricks and bluestone have been used for some of the walls and furniture elements.</p>
	<p>Concrete has a huge carbon footprint, how will this be offset?</p>	<p>We are already using mostly recycled material and we will investigate this further to reduce the use of concrete</p>	<p>The amount of concrete in the project has been significantly reduced. Concrete walls have been replaced with recycled bricks</p>
	<p>Are the surfaces all new or are the materials recycled and repurposed?</p>	<p>Recycled paving options have been explored for the hard surfaces in the pocket parks. Paving patterns and material combinations will be explored in the next phase of the project to make these parks unique, sustainable and inviting places to be.</p>	<p>Recycled materials have been incorporated into walls and paving, refer pages 9 & 10.</p>
	<p>Watering grass uses a significant amount of resource and energy. Will adjoining rooftops be accessed to store rainwater?</p>	<p>Storm water runoff from the streets will be directed into raingardens and filtered through garden beds to reduce the need for irrigation and also treat the water before it enters the stormwater system. Water storage for irrigation will also be explored in the next phase of the project. The privately owned buildings surrounding the spaces have their own storm water discharge systems and ways of managing water which is not practical to connect into this project.</p>	<p>Raingardens have been used to collect surface runoff and water from single story dwellings, refer page 6.</p>
STREET ART	<p>Will there be street art on some of the walls throughout the park network to reduce graffiti?</p> <p>Also we have so many incredible local Melbourne street artists that I'd love to see featured!</p> <p>I'm glad you just mentioned the art wall on the Bangs Park... Is the council going to allow graffiti artists to create murals all around these parks? Otherwise they run the risk of looking quite bland. Graffiti murals and art is such a part of Melbourne's culture. Is it possible to allow several areas to have murals? The Cato Park development was a great asset, and I love it, but it does look quite bland at points without gravity murals...</p>	<p>Murals and artwork on walls are proposed for this project. Council will explore this further in the next phase of the project in consultation with local artists to reflect the character of the area. A structural engineer will be engaged to provide advice on the existing brick walls abutting some of the parks. Where possible, these will be retained and considered for street art.</p>	<p>The Mount Street Precinct masterplan identified several opportunities for artwork installation. Council is currently developing a suitable strategy to source artists, and begin the process of creating these vibrant new additions to the pocket parks. Refer page 13.</p>
CLIFTON STREET SHARED ZONE	<p>Is there any mechanism to discuss with Council the possibility of wrapping the new Anchor Street surface around the corner into Clifton Street, and extending it 10-12 metres past the current entry to 15 Clifton street and up to the driveway entry to our complex at TRILOGI APARTMENTS?</p>	<p>This is a good idea that would further connect the shared zone with Anchor Park. This will be looked at in detail in the next phase of the project.</p>	<p>This idea has been incorporated into the project, refer Masterplan on the cover page</p>
BANGS PARK	<p>One small consideration. Bangs park is currently mostly used for dog toileting. For parks that primarily are focused on people interacting with the grass (e.g. picnics, yoga) additional space for toileting might be considered (e.g. in the render for Bangs park, the strip of undergrowth might be grass instead—separating human activities)</p>	<p>Provision of dog bin bags and signage will be considered for all the pocket parks in the next phase of the project. A specific dog park has not been included in the masterplan due to the physical restrictions on size.</p>	<p>Bins have been included in all Pocket Parks</p>

Shared Zones

The design and implementation of the Shared zones is in accordance with the Vic Roads guidelines. Prior to construction, the project will be reviewed by the Department of Transport to ensure that all proposals in this project follow these guidelines.

The Shared Zones will create a new space for the community that allows more than just vehicles to use and feel safe in the space. At either end of the shared zones there will be signage signalling to road users, that they are entering a space with different conditions and different rules. The speed limit in the shared zones will be reduced to 10km to make these spaces safer for all users. Bollards, seating, rain gardens and trees will be utilised to create safe pedestrian spaces on the edges of the shared zones. Flush transitions allow easy access around the shared zones and connections to the pocket parks.

As communicated in the Masterplan stage and earlier community consultation sessions, car parking will be removed within the shared zones. In order to achieve an improved community space, a balance between vehicles and other modes of transport needs to be achieved. Car parking either side of the shared zones will be retained with new signage installed to make parking locations clear.



Detail graphic plan of area

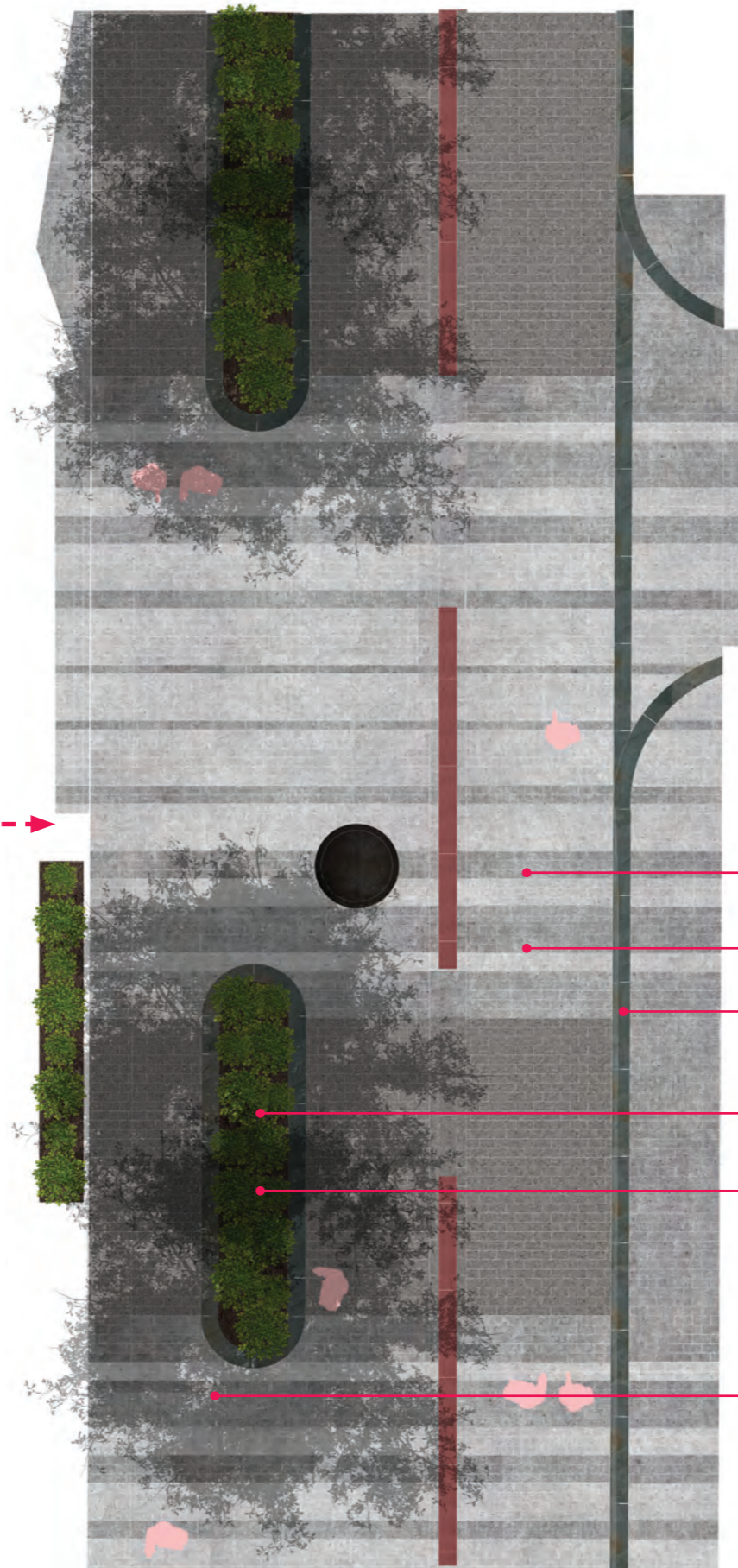

Reduction of speed limit from 40km/h to 10km/h within shared zones

Crossovers into existing properties will be maintained

The shared zones will be flush paved surfaces.

In Regent Street edging is required on the east side to manage storm water

Canopy trees for shade

Raingardens collect surface run off water and filter through dense native planting, cleaning the water before it flows into the storm water system.

Downpipes from properties will be redirected into the raingardens where possible. Large apartment developments are legally required to manage any water that hits the site, so these are not directed into the raingardens.

Raingardens and bollards are used to create a barrier for pedestrians on either side of the shared zones

Masterplan showing Mount Street, Remo Park, Regent Street and Bangs Park

Regent Street, detail graphic plan

Seating elements and tables on the edges of the main pathway

Large garden beds with diverse native planting

Recycled bluestone pitchers in garden beds

Boundary fence

Pocket Parks

The Pocket Parks create inclusive spaces for all community members to use and enjoy. Open lawn areas and various seating elements provide spaces for the community to gather, socialise and exercise.



Mouclif Park East Perspective

Bluestone and granite banded paving to all shared zones.

A band of permeable paving surrounds the raingardens to provide additional water and space for the trees roots to promote healthy growth.

Raingardens collect surface run off water and filter through dense native planting, cleaning the water before it flows into the storm water system. Downpipes from properties will be redirected into the raingardens where possible. Large apartment developments are legally required to manage any water that hits the site, so these are not directed into the raingardens.

Pocket Parks

Community vegetable gardens were considered for the Pocket Parks and a conclusion was reached that they're not the best location for the following reasons:

1. Community gardens are relatively big spaces and the available space in the Mount Street pocket parks are small and limiting when compared with other community garden spaces.
2. The site for a community garden should accommodate social gathering spaces: shelter, picnic table, wash station, bike parking etc as well as veggie plots. There is not enough space in any of the pocket parks for these extra facilities.
3. The space should be a dedicated area that can accommodate planting beds for multiple groups and a growing membership.

3m central path made from a combination of colourful bricks

Solar lights in the parks

A line of red bricks will connect all the Shared Zones and Pocket Parks. The bricks will be an edge to paving that occasionally extends up into a wall or a seating element. The bricks visually bring the whole project together

Feature deciduous trees to allow Winter light through to the Pocket Parks.

Open grass areas for picnics and activities



Bangs Park Perspective

Shared Zones

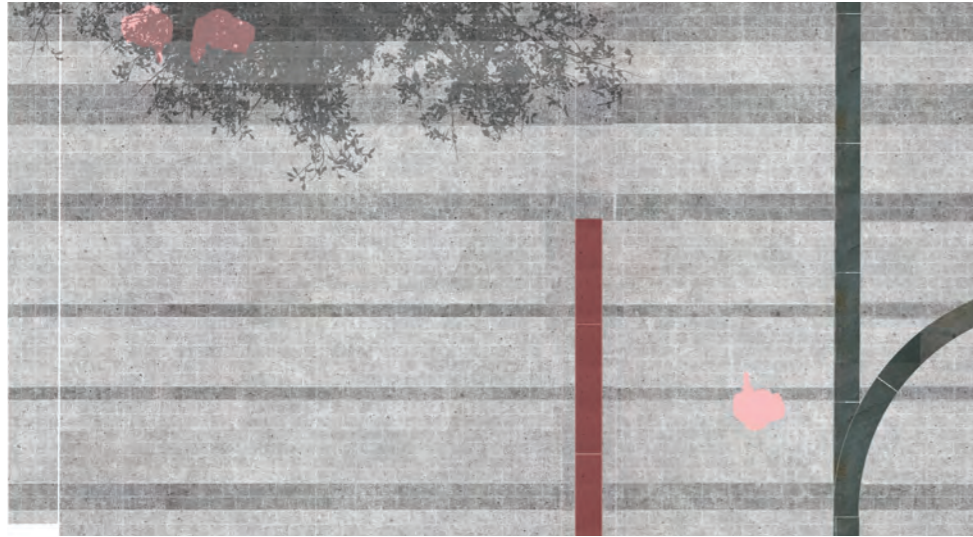

Shared Zone, detail graphic plan



Bluestone, granite and permeable pavers in varying finishes for Shared Zones



Bands of permeable paving used around raingardens

Pocket Parks

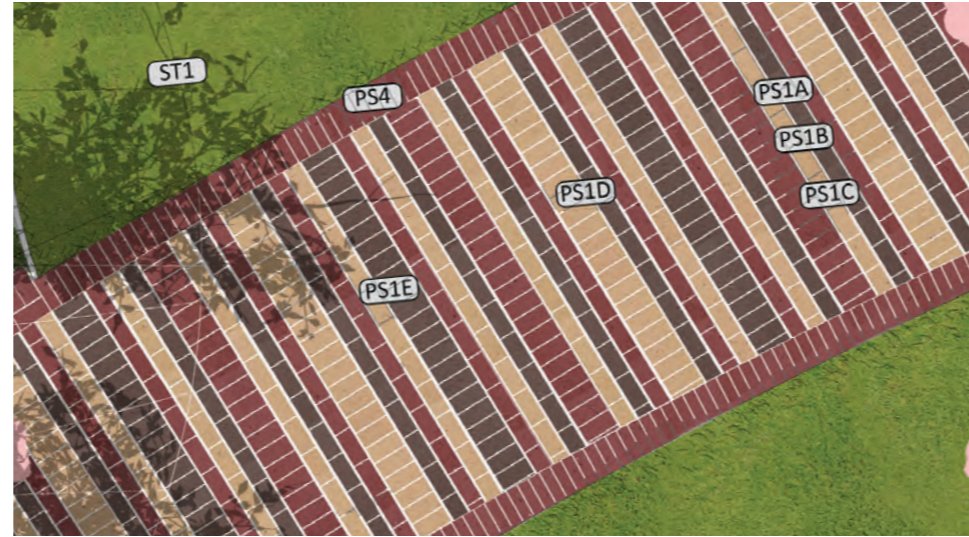

Pocket Park, 3m 'Catwalk' path graphic plan



Pocket Parks, 3m 'Catwalk' proposed bricks with Shared Street bluestone

Materials

In the shared zones that will have regular vehicle traffic, a natural stone mix of bluestone and granite has been specified for its durability. Bands of permeable paving, with a similar colour palette to the bluestone and granite, will surround the raingardens to provide additional water and space for the trees roots to grow. A line of red bricks will connect all the Shared Zones and Pocket Parks. The bricks will be a feature line through the shared zones and an edge to paving in the pocket parks that occasionally extends up into a wall or a seating element. The bricks will visually tie the whole project together.

Brick paving was selected for the main pathways in the pocket parks for the low embodied energy of this material. A bright mix of locally sourced bricks form the repeat pattern used on the 3m 'Catwalk' shared path that runs through all the pocket parks.

Materials that can be reused from the site have been included in the project where possible. The bluestone pitchers that are currently used for the kerb and channel down Regent Street, will be reused as stepping stones within the proposed garden beds.

One of the comments that came up often in the previous rounds of community consultation was the amount of concrete that this project was proposing to use. As a result, the majority of the concrete walls have now been replaced with recycled brick walls. This makes the project significantly more sustainable but also adds a character that will make this place distinct. There are still a few locations where concrete is still been used in the project. Recycled aggregate and fly ash will be utilised in the concrete mix to make it a more sustainable material.

As part of a broader Stonnington Council strategy, the Mount Street Precinct recently went through a sustainability assessment review. Experienced sustainability consultants looked at the details of the whole project and put forward a list of recommendations for consideration. Many of these recommendations have been implemented on this project and informed how Stonnington Council can improve the approach to future local projects.



Boundary fence



Fence for climbers

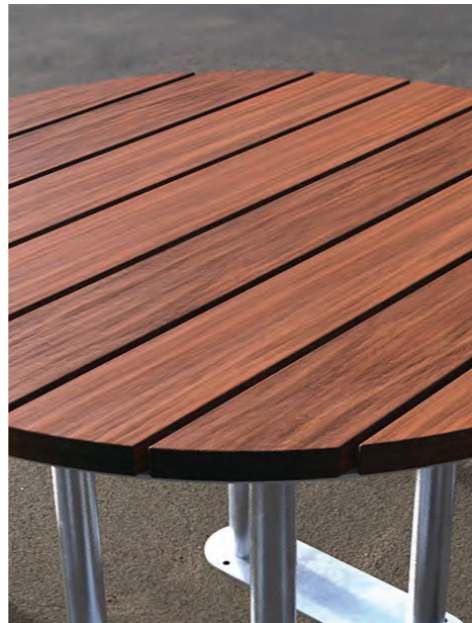

Circular timber picnic table



Recycled brick wall

Furniture

The furniture throughout the Mount Street Precinct has been refined with the addition of recycled brick walls and new brick paving. The brick element carries through as a base to many of the furniture types in the project. In the images opposite you can see how timber setaing with backrests has been incorporated into the continuous brick wall element, that in some form continues through all of the Shared Zone and Pocket Park spaces. Existing brick walls that will be transformed into canvases for new artworks make up the edges to many of the Pocket Parks. Other edges will be established with simple timber fences, some with the ability to have climbing plants eventually grow and cover them.



Curved timber seat that will sit on top of recycled brick wall

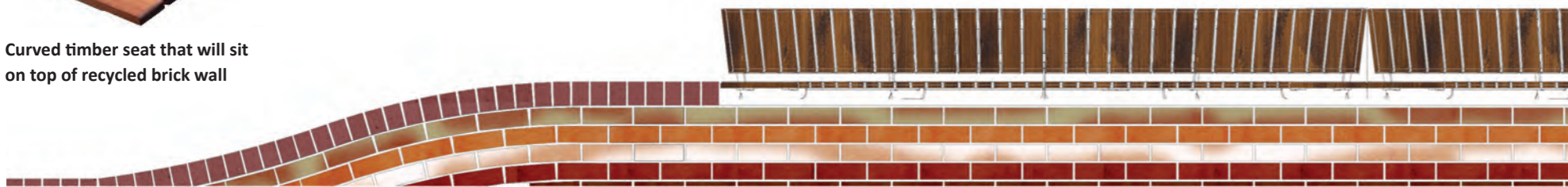

Recycled brick wall with curved timber seating



Mouclif Park render showing recycled brick walls, curved seating and the coloured brick 'Catwalk' path



Bicycle racks



Bollards

Planting

The Mount Street precinct proposes a series of planted raingardens and Pocket Parks with large dense shrub planting. All of the groundcovers, shrubs and grasses used through the Precinct are native species, with some of them indigenous to the area. The indigenous plants are specific to this area and also reference the indigenous background of the place. Nearly all of the proposed trees are also native with the exception of locations where light is particularly important. In these locations, around the Pocket Parks, large deciduous trees have been used to allow Winter light into the spaces.



Quercus palustris



Eucalyptus mannifera



Melaleuca ericifolia



Banksia integrifolia



Brachychiton acerifolius



Hakea laurina



Adenanthus sericeus



Correa alba



Eremophila nivea



Rhagodia spinescens



Lasiopetalum behrii



Correa x 'Dusky Bells'



Dianella longifolia



Ficinia nodosa



Poa morrissii



Carex apressa



Juncus flavidus



Lomandra confertifolia



Dianella caerulea



Lomandra longifolia



Hardenbergia violacea



Grevillea lanigera



Kennedia beckxiana



Chrysocephalum apiculatum



Plectranthus argentatus



Dichondra repens



Eleocharis gracilis



Myoporum parviflorum



Chrysocephalum semipapposum

Lighting

The Pocket Parks use a solar light that has the capacity to store energy and sustain lighting for 10 days without any form of sunlight. The sophisticated lightpoles also have the ability to absorb solar energy from reflected light from surrounding buildings. This feature provides a safe and sustainable form of lighting the parks in 2022 and also future proofs the park against future developments that could reduce the amount of sunlight the solar light poles receive. Feature lighting to furniture and garden bed edges, along with uplighting to artwork walls will softly light the pocket parks at night.

The lighting within the shared zones will also be upgraded as part of Citipower works within the Mount Street area streets.



Pocket Park solar lights



Shared Street lighting

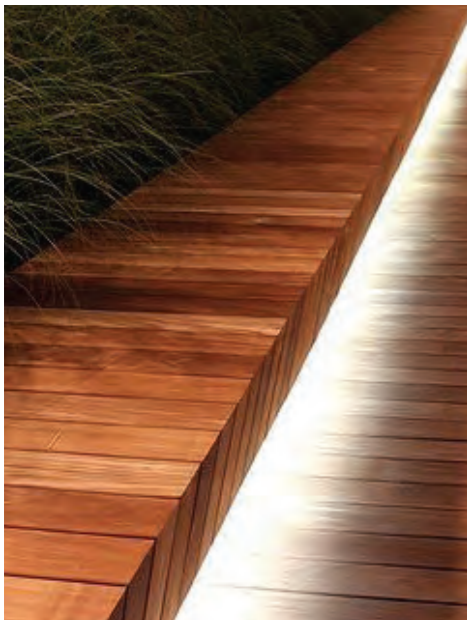

Bench feature lighting

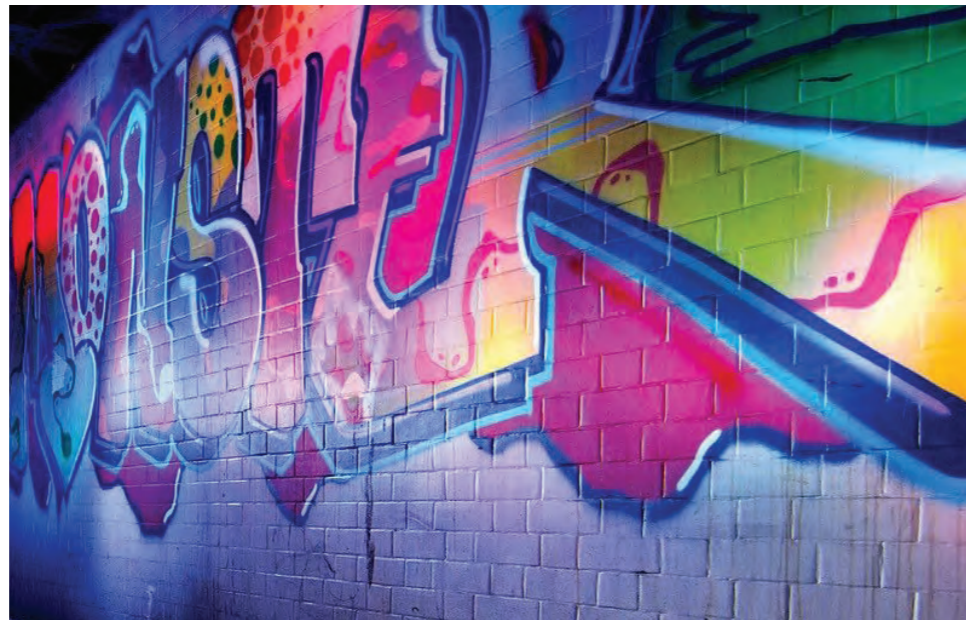

Art wall uplighting



Raingarden lighting

Street Art

The Mount Street Precinct masterplan identified several opportunities for artwork installation. Council is currently developing a suitable strategy to source artists, and begin the process of creating these vibrant new additions to the pocket parks. Please note that artworks presented on this page are indicative only.



Anchor Park proposed art wall



Anchor Park render



Mouclif Park proposed art wall



Mouclif Park render



Bangs Park proposed art wall



Bangs Park render

Next Steps

In the last few months, Stage 1 of the project has been documented to prepare drawings for construction. Stage 1 includes the East portion of Mouclif Park, Regent Street Shared Zone and Bangs Park. Works will commence on Stage 1 in 2022. Further information will be provided closer to the construction date.

