

**LEGEND**

- Existing Site Elements to be removed
- Trees
- Existing Concrete Path
- Proposed Concrete Path
- Proposed Feature Paving Type 1
- Proposed Feature Paving Type 2
- Proposed Grassed Area
- Existing Fence
- Proposed Fence
- Proposed / Existing Gates
- Proposed Spectator Seating
- Proposed Seats
- Existing Seats
- Proposed Drink Fountain with Dog Bowl
- Proposed Sports Lighting Poles
- Proposed Pathway Lighting Poles
- Main Reserve Entries
- Future Opportunity for Entries to Reserve and Pedestrian Links
- Surrounding Pedestrian Links
- Proposed High Ball Protection Fence
- Proposed Public Toilets

**EXISTING FEATURES TO BE REMOVED / UPGRADED**

- Pavilion
- Public Toilet Block
- Old Cricket Pavilion
- Victory Square Pavilion
- Synthetic Cricket Nets
- Turf Practice Pitches
- Telecommunications Facility
- Water Tank
- Synthetic Cricket Pitch
- Playground
- Fixed Screens
- Shed

## LANDSCAPE AND VEGETATION

- 1 Protect and retain mature trees throughout the site where appropriate, importantly trees of high retention value.  
  
Protect and retain existing trees along the northern boundary of Toorak Park and Victory Square to provide a visual buffer to the 590 Orrong Road development and natural shade.  
  
Undertake selective removal of trees to establish pathway connections and to construct the new pavilion.  
  
Install additional canopy trees throughout the site for shade, visual amenity and buffering.
- 2 Remove selected areas of the existing earth mounds surrounding the main oval to form pathway connections, improve oval quality and improve sightlines. Create new earthmounds where feasible to minimise soil removal off site.
- 3 Provide retaining wall, landscape buffer treatment and noise attenuation solution to cricket training/multi use facility in the south east corner.

## BOUNDARIES, PARKING AND ROAD INTERFACES

- 1 Improve boundary treatments, connectivity and safety through replacing high boundary fences with low fences, selectively thinning out vegetation where appropriate and providing pedestrian links.
- 2 New pavilion to incorporate an active frontage to Orrong Road to improve visual appeal, presence and pedestrian entry. Investigate opportunities to incorporate on site basement car parking into the new pavilion.
- 3 Improve parking treatments within surrounding streets. Undertake traffic management planning to identify improved traffic management opportunities, particularly along Fulton St, Aubrey St (South) and Webster St owing to the loss of parking in Potter St & Aubrey St (North).
- 4 Provide dedicated maintenance and emergency vehicle access points into the site as required. Maintenance access to Victory Square via the new reserve entry off Fulton Street.

## ACCESS AND CIRCULATION

- 1 Implement a formal pathway network throughout the reserve and improve public lighting for safety.
- 2 Utilise land acquired in the south east corner to provide a new feature pedestrian entry to improve access into the reserve for local residents and to/from High Street. Provide shared maintenance and emergency vehicle access.
- 3 Relocate cricket nets off the main oval to improve pedestrian access into the reserve and around the oval.
- 4 Future opportunity to establish pedestrian connections along the northern boundary to provide access to Toorak Park / Toorak Station and Orrong Road.
- 5 Establish new entries and enhance existing entries through feature landscape treatments and signage to improve access.
- 6 Create a wider accessible footpath along Fulton Street car parking to improve access.

## SPORTS FACILITIES AND BUILDINGS

- 1 Remove the 12 turf and 3 synthetic practice nets off the main oval and provide a new enclosed multi use facility in the south east corner of the site
- 2 Create a more consistent oval shape by increasing the south east oval boundary and undertake a full ground renovation including drainage and irrigation to improve playing conditions. Laser level to remove the significant crown on the ground.  
  
Replace the centre turf wickets and rotate to better align with the new oval shape.  
  
Replace oval boundary fencing and gates as required.
- 3 Remove redundant infrastructure from the site including Victory Square pavilion, public toilet block, telecommunications facility, water tank, fixed screens and shed.
- 4 Consolidate Charles Lux pavilion and the cricketers building into a new shared pavilion to better support future needs and meet standards.
- 5 Incorporate new high ball protection fencing within the oval fence line at either end of the main oval and between Victory Square.
- 6 Provide formalised seating around the main oval incorporated into existing earth mounds.
- 7 New ground curator/storage shed with public toilet.
- 8 Relocate existing water tanks/bore into an underground facility.

## COMMUNITY RECREATION AND PARK AESTHETIC

- 1 Maintain a high quality grassed open space/dog off leash zone within Victory Square. Fence off from playground and maintain perimeter fencing on northern, eastern and southern boundaries. Remove synthetic cricket pitch and provide a soccer goal or similar for community recreation.  
  
Consider incorporating interpretive elements, signage or feature perimeter fencing/walls to reference the history of Victory Square.
- 2 New accessible playground and picnic area with BBQ and shelter to be located along the Ashleigh Road boundary of Victory Square. Playground to be fenced on all four sides and expanded to provide a diverse range of play opportunities for children of all ages and abilities.
- 3 Incorporate public toilets within the new pavilion and the new curator/storage facility.
- 4 Multi-purpose synthetic area to be available year round for community use outside designated seasonal cricket training times. Consider options such as futsal goals, basketball/netball rings and tennis hit up wall to provide community amenity.
- 5 Provide a drinking fountain with dog bowl in Victory Square.

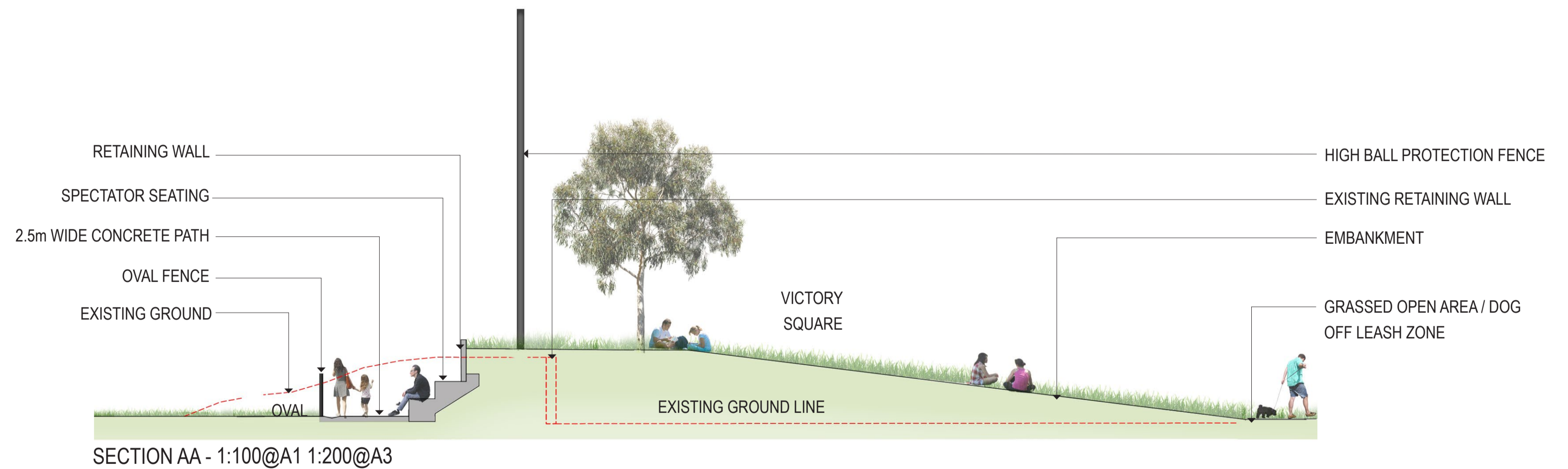
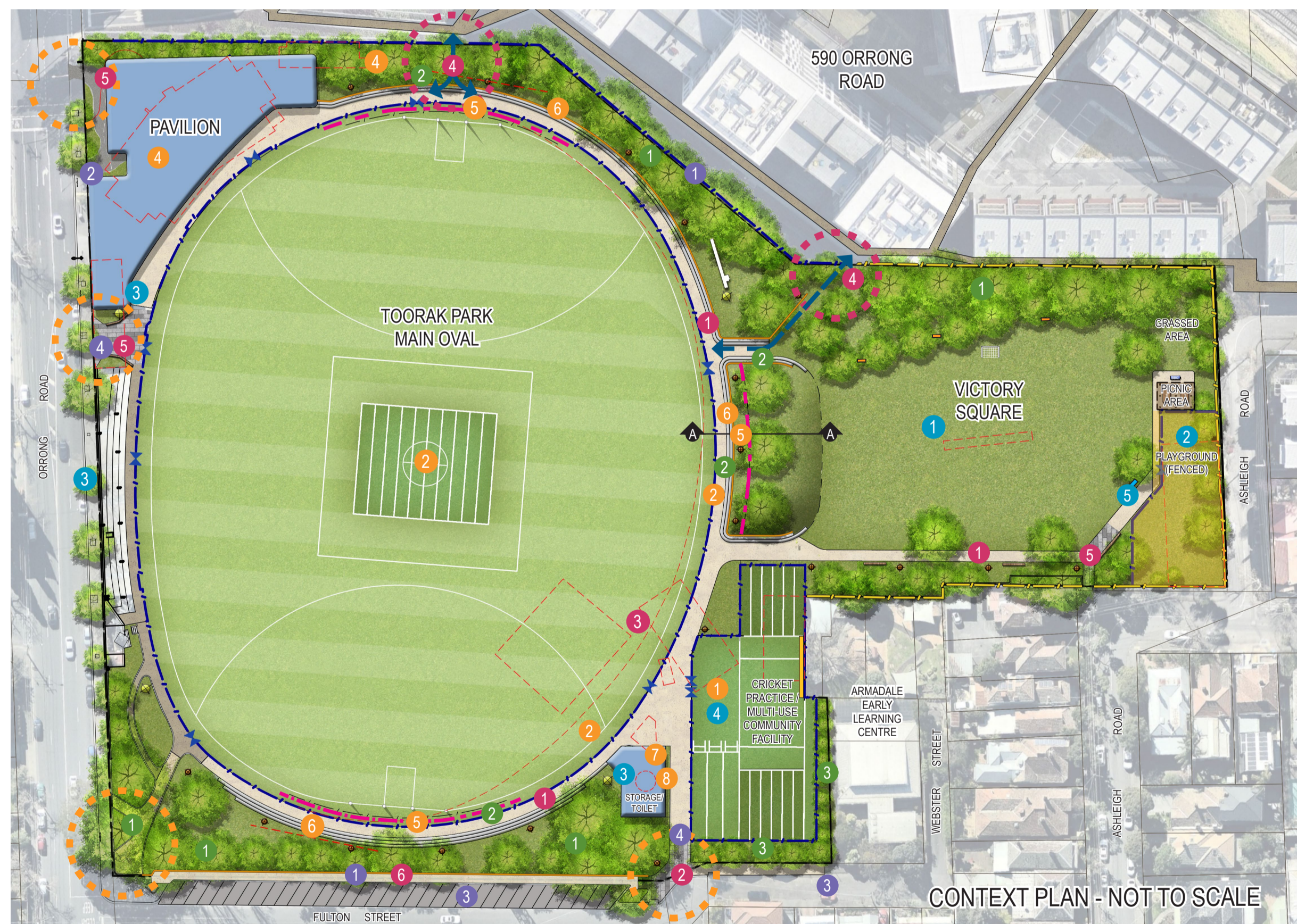

### PRECEDENT IMAGES



FEATURE ENTRIES    PICNIC AREA    PUBLIC TOILETS    PLAYSACE    TERRACED SEATING    FULLY ENCLOSED CRICKET PRACTICE FACILITY    BLACK PVC COATED CHAIN MESH FENCING TO OVAL    OVAL BOUNDARY FENCE    PAVILION    HIGH BALL PROTECTION FENCE    MULTI-PLAY COURT    TENNIS HIT UP WALL